

DARTTM

HITS THE MARK



FOCAL POINT

DART™ IS ALWAYS DEAD ON

Don't be fooled by Dart's petite stature, this powerful profile delivers unparalleled performance while remaining anonymous in its surroundings. Featuring Right Light™ & Gradient Optic technology Dart exemplifies how linear LED not only saves energy but contributes to a healthy work place that enhances productivity and well-being.

FEATURES

- 90% Indirect illumination
- Acrylic or MicroGlow™ diffuser
- Optional Beam Smoothing Diffuser
- 5 Standard output levels
- 3000K, 3500K, 4000K
- CRI >80
- 0-10V dimming in 10% and 0%
- Lutron, Dali & Step dimming options
- Up to **106 LPW**
- **DLC Listed**
- L90 at 77,000 hours
- 5 year limited warranty



ACTUAL SIZE



**LINEAR
SUSPENDED**



**ASYMMETRIC
WALL MOUNT**

Providing additional design flexibility, Dart's complimentary wall mount version provides design continuity throughout an entire space.



BEFORE ADJUSTMENTS



STANDARD GRADIENT OPTIC



OPTIONAL BEAM SMOOTHING DIFFUSER*

*Supplied as standard with Emergency Battery

TARGETED BEAM CONTROL

Dart utilizes our Gradient Optic, a saw tooth reflector that diffuses the edges of the indirect distribution, to prevent harsh lines on vertical surfaces. The Gradient Optic also directs light down through the lens, and dampens the brightness directly above the luminaire. The optional Beam Smoothing Diffuser, recommended for applications where luminaires are mounted in close proximity to walls, provides additional beam softening.

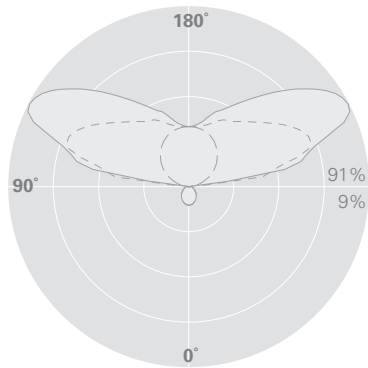

GRADIENT OPTIC

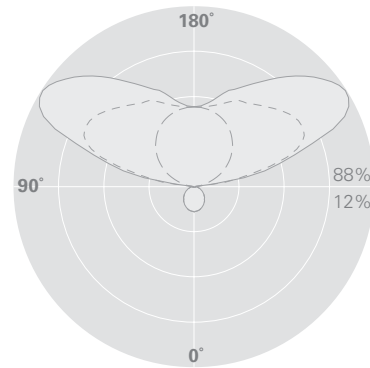

**BEAM SMOOTHING
DIFFUSER**

For maximum visual comfort combine the Beam Smoothing Diffuser with our low-brightness MicroGlow lens.

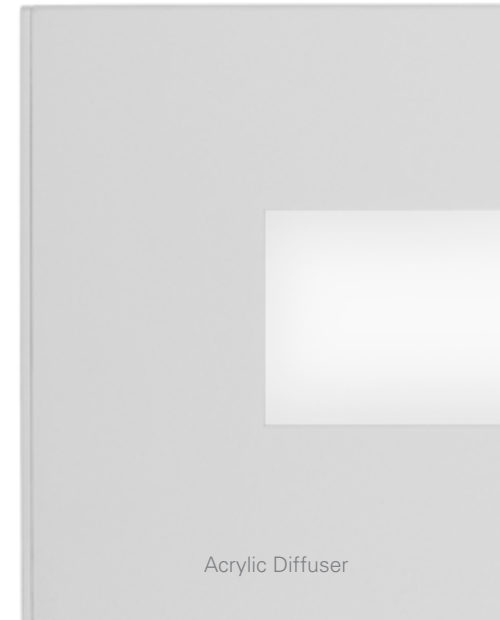



SPOT ON PERFORMANCE

LUMEN OUTPUT	4' SUSPENDED					4' WALL MOUNT		
	750LF	875LF	1000LF	1125LF	1250LF	625LF	750LF	875LF
DELIVERED LUMENS	2880	3360	3840	4320	4800	2411	2988	3391
SYSTEM WATTAGE	27	33	38	44	50	26	32	38
LPW	106	102	101	98	97	94	93	88

20' x 40'

LUMEN OUTPUT	SHIELDING	AVERAGE FOOTCANDLES	CEILING UNIFORMITY	WORKPLANE UNIFORMITY	WATTS/SQ. FOOT
10' CEILING, 18" Suspension, 12' spacing					
750LF	Acrylic or MicroGlow	27.6	6.6	2.5	.45
875LF	Acrylic or MicroGlow	31.1	6.6	2.5	.55
1000LF	Acrylic or MicroGlow	35.6	6.5	2.5	.64
1125LF	Acrylic or MicroGlow	40.0	6.6	2.5	.73
1250LF	Acrylic or MicroGlow	44.5	6.6	2.5	.83

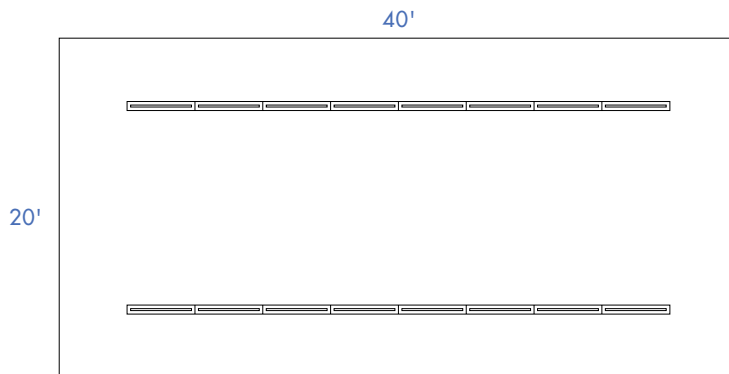

Light Levels calculated in AGI-32.
0.85 Lightloss factor.
80/50/20 reflectances.

Color temperature: 3500K.
Lumen output may vary +/- 5%.
Actual wattage may vary +/- 5%

RIGHT LIGHT™

Our Right Light™ system provides several standard output levels. We will always support these output levels for Dart, so you will never have to think or recalculate your design. Request alternate levels within the standard range for even more control of light levels and energy consumption. Factory-programmable drivers enable this exceptional versatility, so you can deliver the Right Light for any space.

See all our Right Light enabled luminaires at focalpointlights.com/products/rightlight.

LUMEN MAINTENANCE

Dart is designed to last. Cool running mid-power LEDs are projected to maintain 90% of their initial output for 77,000 hours.

PER TM-21 CALCULATOR

Calculated L90	77,000 hrs
Reported L90	>37,000 hrs

WALL MOUNT

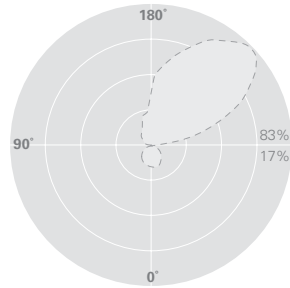
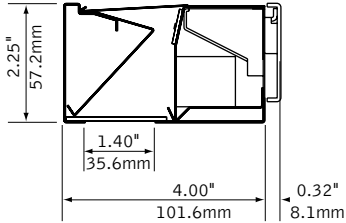

ASYMMETRIC DISTRIBUTION

Fixture Series	FDALW
Dart LED	FDALW
Shielding	
Acrylic Diffuser	AC
MicroGlow Prismatic Lens	MG
Lumen Output	
625 Lumens per foot	625LF
750 Lumens per foot	750LF
875 Lumens per foot	875LF
Color Temperature	
3000K	30K
3500K	35K
4000K	40K
Circuits	
Single Circuit	1C
Voltage	
120 Volt	120
277 Volt	277
UNV Volt	UNV
Driver	
<small>(See driver reference for driver quantities)</small>	
0-10V - 10% Dimming	LD1
Lutron A-Series	
1% EcoSystem Driver	L3D
<small>(Consult factory for 3-wire control)</small>	
DALI - 10% Dimming	DD1
DALI - 0% Dimming	DZ1
Step Dimming	SD5
Mounting	
Wall Mount	WM
Factory Options	
Emergency Circuit	EC
<small>(Not available in 6' units)</small>	
Emergency Battery	EM
<small>(Not available in 6' units)</small>	
<small>(Sensor options available—consult factory)</small>	
Finish	
Titanium Silver	TS
Matte Satin White	WH
Fixture Run Length	
4'	4'
6'	6'
<small>(Can not be combined with 4' & 8' lengths to create longer run length)</small>	
8'	8'
12' (8'+4')	12'
16' (8'+8')	16'
20' (8'+4'+8')	20'
24' (8'+8'+8')	24'

(Individual units may not be field modified for continuous row mount)

LINEAR SUSPENDED

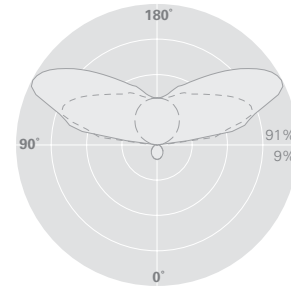
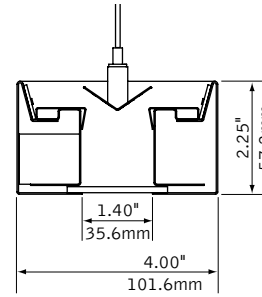

DISTRIBUTION



INTEGRATED SENSORS

(Consult factory for availability)

Fixture Series	FDALS
Dart LED	FDALS
Shielding	
Acrylic Diffuser	AC
MicroGlow Prismatic Lens	MG
Lumen Output	
750 Lumens per foot	750LF
875 Lumens per foot	875LF
1000 Lumens per foot	1000LF
1125 Lumens per foot	1125LF
1250 Lumens per foot	1250LF
<small>(Not available with L3D driver)</small>	
Color Temperature	
3000K	30K
3500K	35K
4000K	40K
Circuits	
Single Circuit	1C
Voltage	
120 Volt	120
277 Volt	277
UNV Volt	UNV
<small>(Cannot be specified with EM option)</small>	
Driver	
<small>(See driver reference for driver quantities)</small>	
0-10V - 10% Dimming	LD1
Lutron A-Series	
1% EcoSystem Driver	L3D
<small>(Consult factory for 3-wire control)</small>	
DALI - 10% Dimming	DD1
DALI - 0% Dimming	DZ1
Step Dimming	SD5
Mounting	
24" Cable Suspension	J24
48" Cable Suspension	J48
96" Cable Suspension	J96
<small>(Add "P" for Chicago plenum. Eg: JP12, CP12)</small>	
<small>(Specify one of the following in place of "J")</small>	
<small>C - for 5" canopies at non-feed locations.</small>	
<small>CS - for sloped ceilings.)</small>	
Factory Options	
Beam Smoothing Diffuser	BSD
<small>(Dust Cover. Supplied as standard with Emergency Battery)</small>	
Emergency Circuit	EC
Emergency Battery	EM
<small>(Not available in 6' units. BSD standard)</small>	
<small>(Sensor options available—consult factory)</small>	
Finish	
Titanium Silver	TS
Matte Satin White	WH
Fixture Run Length	
4'	4'
6'	6'
<small>(Can not be combined with 4' & 8' lengths to create longer run length)</small>	
8'	8'
12' (8'+4')	12'
16' (8'+8')	16'
20' (8'+4'+8')	20'
24' (8'+8'+8')	24'

(Individual units may not be field modified for continuous row mount)