

theory®

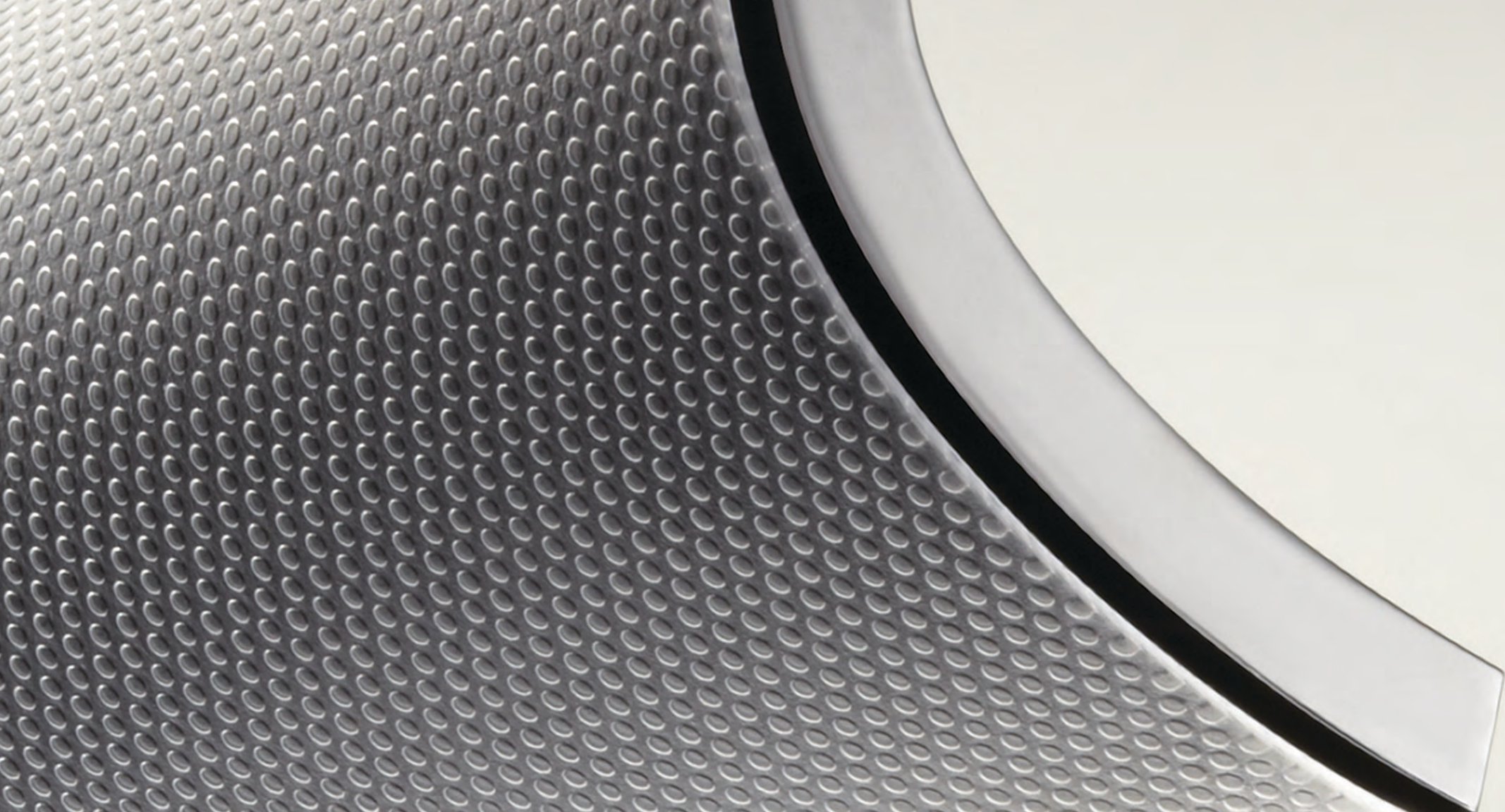

inspire intrigue

We wanted to build something unexpected.

To show what LEDs can do when wrapped in an unconventional skin. The brain child of product designer Graeme Watt, Theory was just that in the beginning. It was an experiment, never meant to become real. Now, Theory changes the way we think about the shape of light.







form

Theory is not defined by its source, rather it becomes the source.

Its elliptical form allows LEDs to be integrated and concealed, gracefully illuminating inside and outside surfaces independently. A curved acrylic light guide draws light around the 4' long body to introduce a sparkling circular pattern. Three distinct lit looks are created, and Theory's luxurious appearance remains even when it is not illuminated.



function

There's a mystery to Theory that is elemental to its design. Where does the light come from? Where does the power come from?

Utilizing LEDs frees Theory from the traditional limitations of lamps and ballasts, and a new design language is formed.

Low voltage power is delivered via elegant and minimal aircraft cable suspensions. Drivers are tucked above the ceiling, and Theory floats unencumbered.

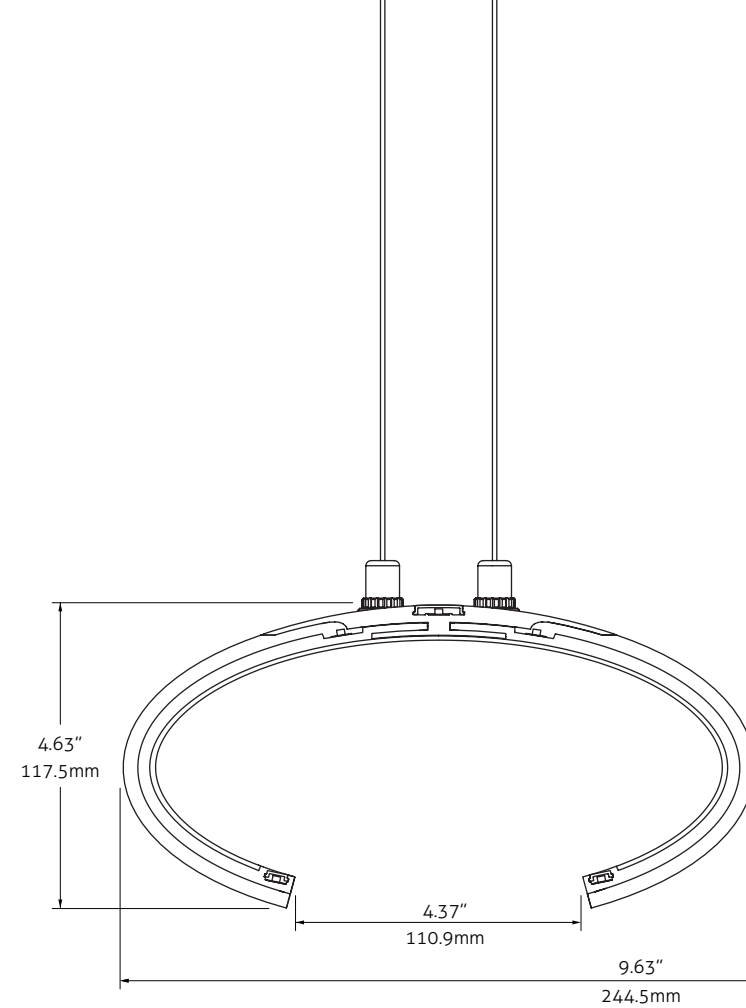



exterior only
2108 lumens



interior & exterior
3373 lumens



interior only
1297 lumens

application

Direct task light and soft indirect light are on separate circuits for maximum flexibility. Use the exterior phase for an ambient glow with visual interest, the interior phase for meetings and task light, and combine them for relaxed and calming whole room illumination.

Separate dimming control allows for **unlimited design and application possibilities.**



construction

The low voltage nature of LEDs allows Theory's glowing form to be decoupled from its power source. In accessible ceilings, mount the power module in the plenum and drop suspension cables through tiny holes in the ceiling tiles. A white satin acrylic canopy elegantly covers the power module in drywall, wood and other hard surface ceilings.

All suspension and power elements are in place prior to installing the fixture, protecting Theory's smooth exterior and chrome endcaps.



hard surface

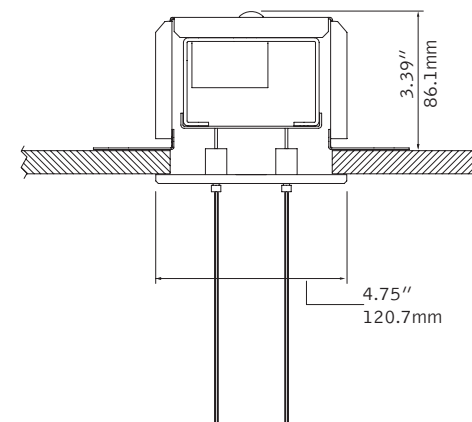

accessible ceiling

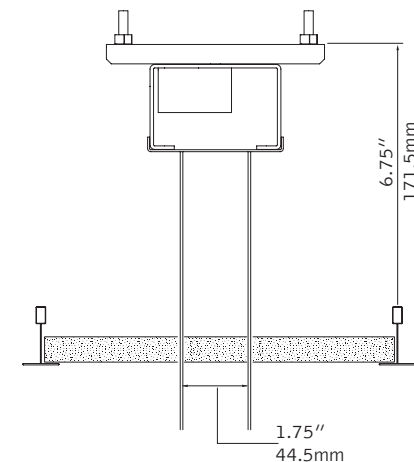

ordering		
luminaire series		FTHPL
Theory		FTHPL
optic		LLP
indirect/direct with luminous patterned light guide		LLP
led system		LL1
Standard Output		LL1
color temperature		
3000K		L30
3500K		L35
circuits		2C
Dual Circuit		2C
voltage		
120V		120
277V		277
driver		
0-10V dimming		LD1
Lutron A-Series - EcoSystem		L3D
Lutron A-Series - Forward Phase		LTE
housing type		
T Rated		T
IC Rated (Hard Surface mounting only. Not available with Lutron drivers.)		IC
mounting		
Accessible Ceiling (grid or other top access)		G
Hard Surface (below ceiling access only, canopy included)		HS
suspension and power feed		CLV60
60" adjustable aircraft cable with integral low voltage power delivery		CLV60

specifications

Each individual pendant is 48" x 9.6" x 4.6" with adjustable low voltage power/suspension cables up to 60".

Theory may be specified in 3000K or 3500K, 0-10v dimming drivers are standard and optional Lutron LED drivers are available.

Lumen maintenance is rated for L70 at 50,00 hours and Theory comes with a 5 year warranty.



©2013 Focal Point LLC.
4141 S. Pulaski Road, Chicago, IL 60632 | T 773.247.9494 | www.focalpointlights.com

Covered by the following US Patents: D605,343, D605,329. European Patents: 001596313–0010, 001596313–0011, 001596313–0012, 001596313–0013, 001596313–0014.
Canadian Patents: CA 132827, CA 132828, CA 135421.

All rights reserved. “Focal Point”, “The Art of Light”, “Theory” and the light-ray graphic are trademarks or registered trademarks of Focal Point, LLC.

Visit focalpointlights.com for specification and other details on our entire catalog.



FOCAL POINT®

T H E
A R T O F
L I G H T®