

# id<sup>®</sup> cfi round housing, emergency & ballast service

FC4 | FC6



**! LUMINAIRE MUST BE INSTALLED PRIOR TO DRYWALL CEILING !**

FOCAL POINT

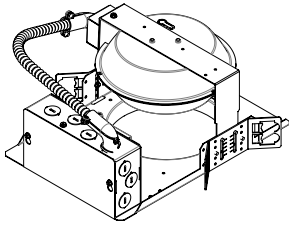

OPTIONAL - SOLD SEPARATELY

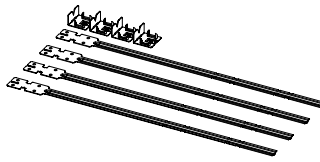

KEY



POWER OFF



POWER ON



LEVEL



ATTENTION



SEE ADDITIONAL INSTRUCTIONS

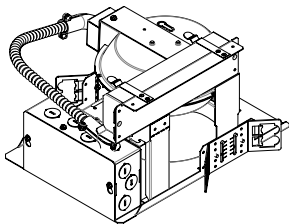

EMERGENCY BATTERY - GRID ONLY

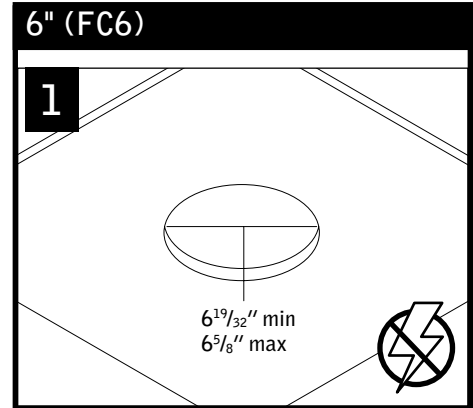
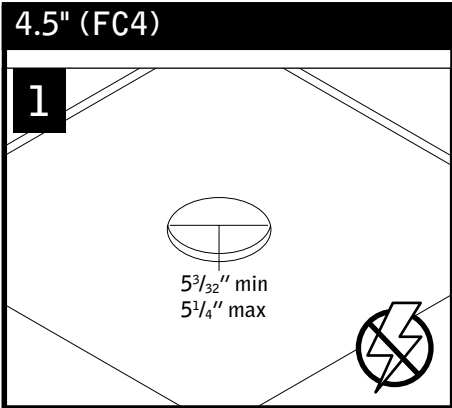

**WALL WASH ORIENTATION**

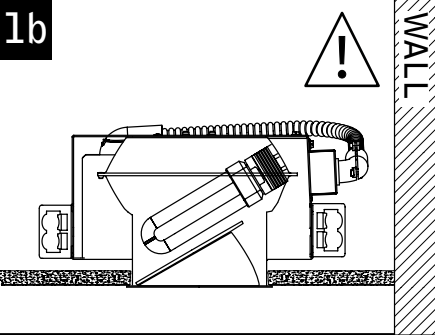

**GRID - 1/2" CONDUIT & CLIP (BY OTHERS)**

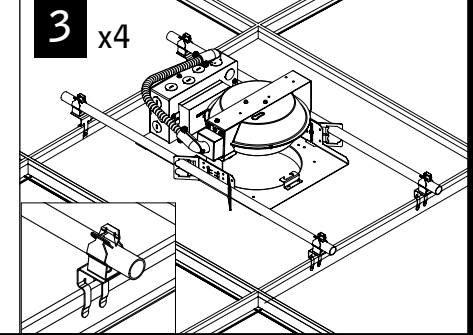
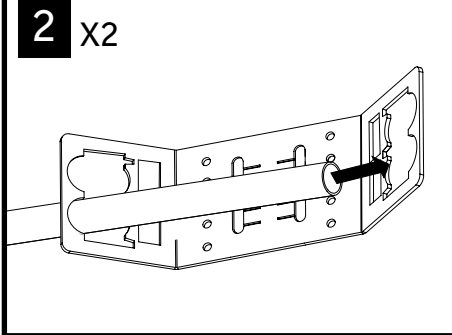

**GRID - BAR HANGERS (SOLD SEPARATELY)**

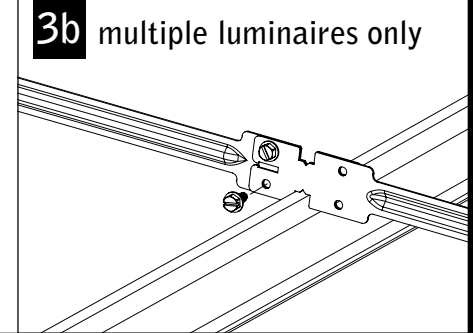
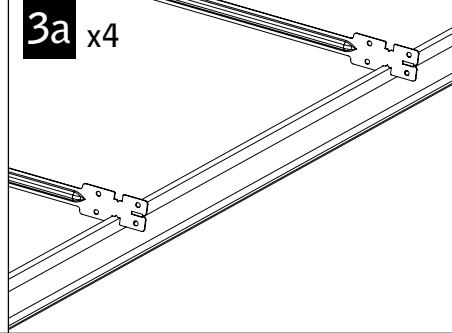
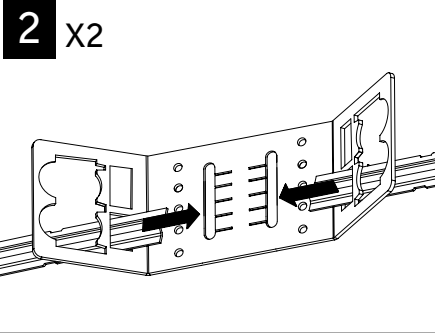

Luminaires must be installed by a qualified electrician (check with local and national codes for proper installation).  
To prevent electrical shock, disconnect electrical supply before installation or servicing.

# DRYWALL - BAR HANGERS (SOLD SEPARATELY)

2 x2

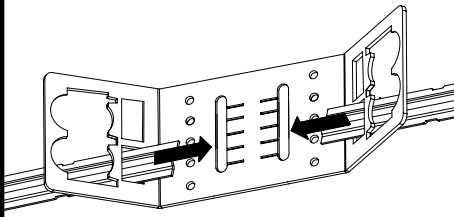

## WOOD STUDS

3a x4

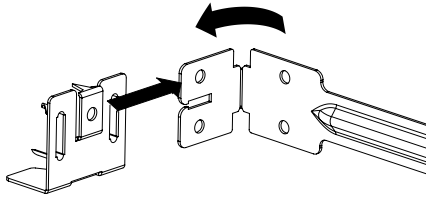

3b x4

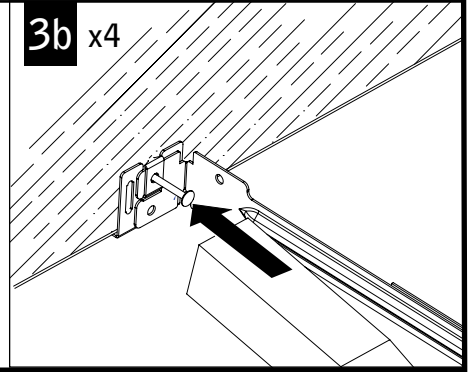

## METAL STUDS

3 x4

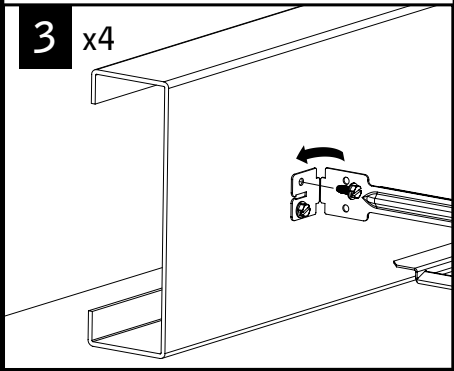

4

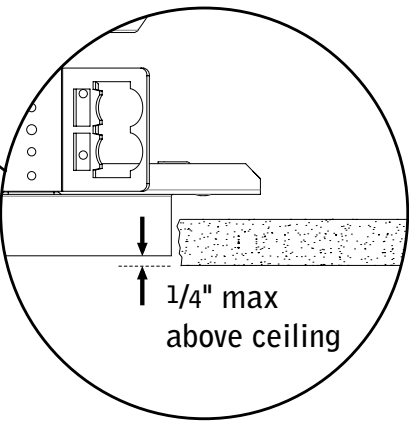
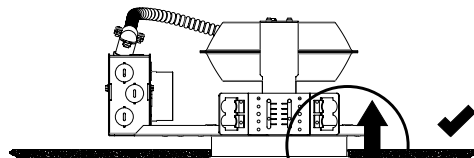
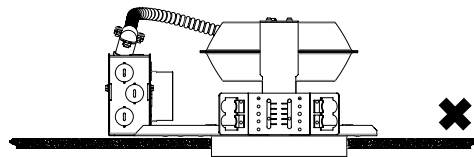

5

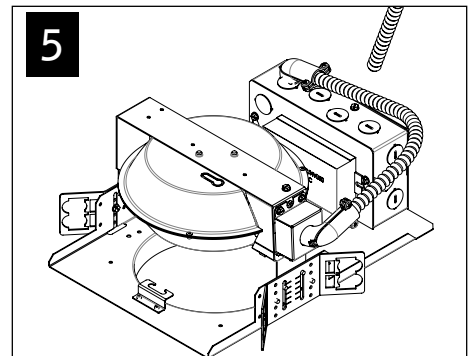

MAKE ELECTRICAL CONNECTIONS

6

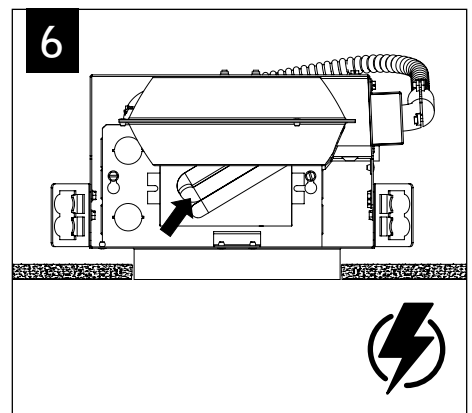

Fixtures must be installed by a qualified electrician (check with local and national codes for proper installation).  
To prevent electrical shock, disconnect electrical supply before installation or servicing.

## EMERGENCY BATTERY (OPTIONAL - GRID ONLY)

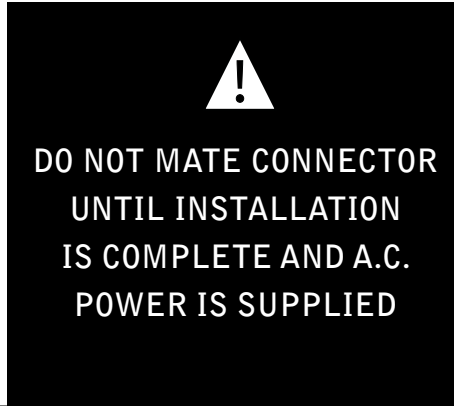
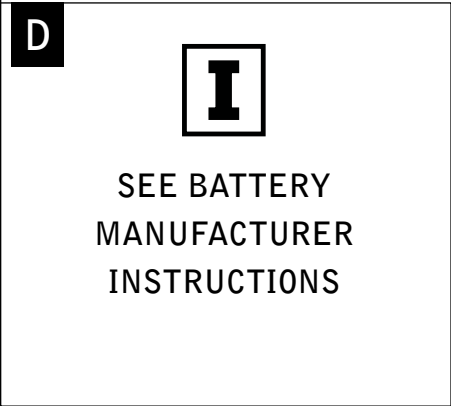
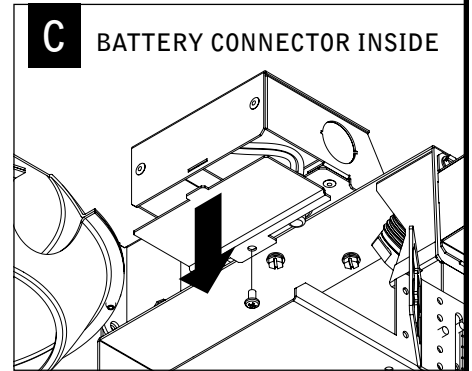
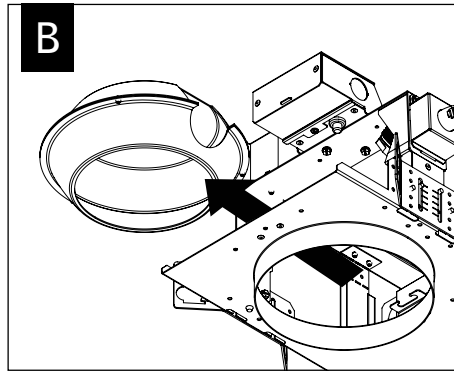
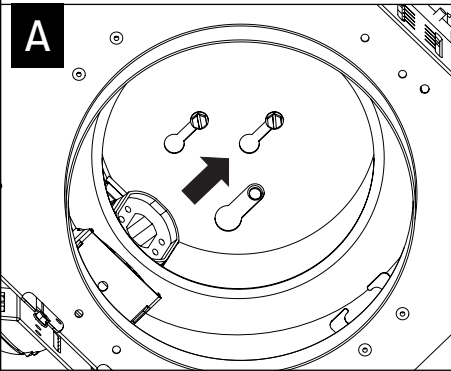

## BALLAST SERVICE

**1** REMOVE TRIM  
(SEE TRIM REMOVAL ON FOCAL POINT INSTRUCTION SHEET IS0276)

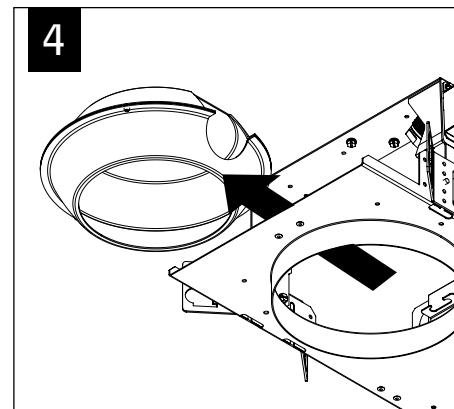
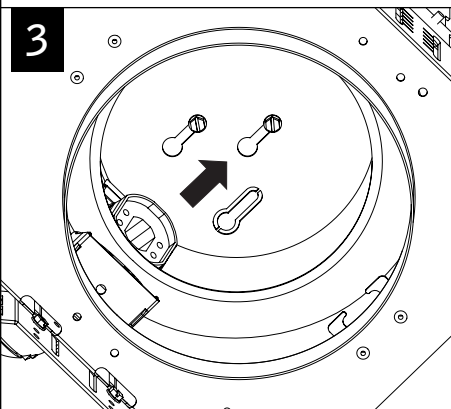

**2** REMOVE LAMP

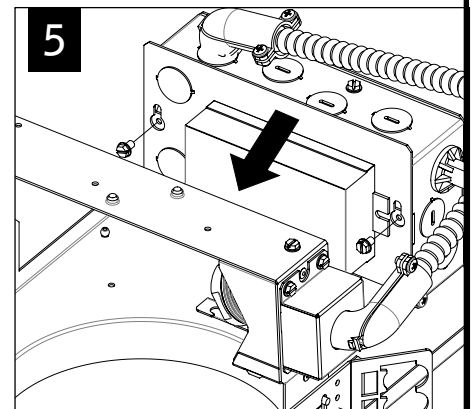

Contractor is responsible for adequately reinforcing walls and/or ceilings to support fixture weight. Focal Point, LLC accepts no responsibility for inadequately reinforced walls and/or ceilings. The information contained in this drawing is the sole property of Focal Point, LLC. Any reproduction in part or whole without the written permission of Focal Point, LLC is prohibited.