

# Veer® 1x4

FLUORESCENT

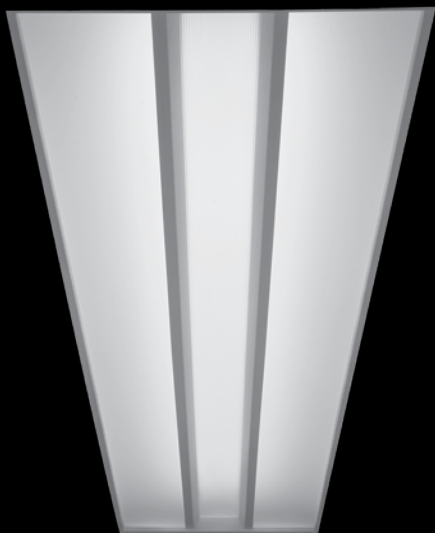

flat diffuser



radial diffuser



suspended or  
surface mount

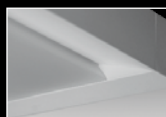

linear companion

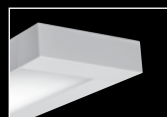

wall mount  
companion

## DIMENSIONAL DATA

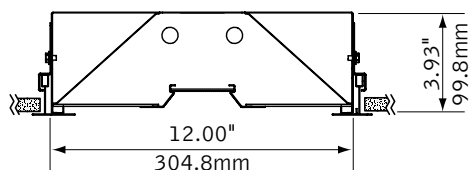

Overall height for luminaire with Air Return is 4.58"

### shielding options



regress

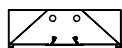

flat



radial

### lamping



T5/T5HO Lamps



T8 Lamps

## FEATURES

High efficiency architectural recessed fluorescent luminaire.

Three distinctive aesthetics offer contemporary styling, and complement architecture.

MicroGroove™ diffusers add texture and visual interest with a ribbed pattern that minimizes lamp image.

## PERFORMANCE

### PRODUCT OVERVIEW

Lumen Output: 2473-7790lm

Wattage: 33-120W

Lamping: T5, T5HO, T8

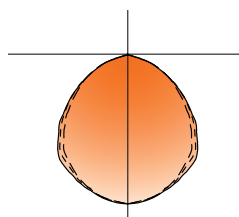

Regress Acrylic Diffuser  
1-lamp T5

**85.3% Efficient**

**956 cd @ 0°**

Visit [focalpointlights.com](http://focalpointlights.com) for complete photometric data.

fixture:

project:

SUSPENSION INFORMATION

**grid**

specify "G" for flat 9/16" and 15/16" tee or "ST" for 9/16" slot tee grid types.

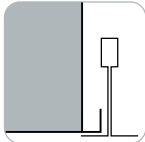

"G" flat tee  
Luminaires may be installed in T-bar ceiling systems up to 1 11/16" high\*.

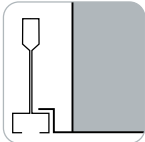

"ST" slot tee  
Luminaires may be installed in T-bar ceiling systems up to 1 11/16" high\*.

**drywall frame kit**

specify "DF" Drywall Frame Kit for drywall ceiling conditions.

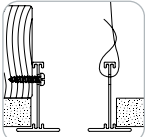

Use tie-wire or screws to secure frame kit.

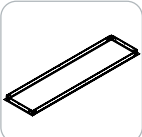

cut out dimensions:  
1': Min: 12.25"  
Max: 12.563"  
4': Min: 48.25"  
Max: 48.563"

SPECIFICATIONS

Construction

One piece 20 Ga. steel reflector and housing. 20 Ga. steel ends. Positional brackets supplied as standard. Weight: 25 lbs.

Optic

20 Ga. steel reflectors finished in matte satin white powder coat. .095" thick frosted white acrylic diffusers with linear MicroGroove™ pattern.

Electrical

Electronic ballasts are thermally protected and have a Class "P" rating. Consult factory for dimming specifications and availability.

Labels

UL and cUL listed.

Finish

Polyester powder coat applied over a 5-stage pre-treatment. Optional Matte Satin White with anti-microbial coating provides 99.99% protection against a broad spectrum of micro-organisms.

ORDERING

Luminaire Series	FVR	FVR
Veer	FVR	
Nominal Size		14
1' x 4'	14	
Shielding		
Radial Acrylic Diffuser	ACR	
Flat Acrylic Diffuser	ACF	
Regress Acrylic Diffuser	ACG	
Lamp Quantity		
One Lamp	1	
Two Lamp	2	
Lamp Type		
T5	T5	
T5HO	T5HO	
T8	T8	
Circuit		
Single Circuit	1C	
Dual Circuit	2C	
Voltage		
120 Volt	120	
277 Volt	277	
347 Volt	347	
(Consult factory for dimming options)		
UNV Volt	UNV	
(Cannot be specified with 1-lamp T5HO dimming or EM option)		
Ballast		
Electronic Program Start <10% THD	S	
0-10V	D7	
Lutron 1% 3-wire	DH	
Lutron 1% H-Series	DK	
Mounting		
24" Aircraft Cable	C24	
48" Aircraft Cable	C48	
96" Aircraft Cable	C96	
Drywall Frame Kit	DF	
(Cut out dimensions: Min: 12.25"/Max: 12.563" Min: 48.25"/Max 48.563")		
Grid	G	
Slot Tee	ST	
Surface Mount	SM	
Factory Options		
Air Return	AR	
Chicago Plenum	CP	
Emergency Battery Pack*	EM	
HLR/GLR Fuse	FU	
6' New York City Flex Whip	FNY	
6' Flex Whip	FW	
Include 3000K Lamp*	L830	
Include 3500K Lamp*	L835	
Include 4100K Lamp*	L841	
Finish		
Matte Satin White	WH	
Matte Satin White with Anti-Microbial Coating	WHA	