

Seem® 1

LED WALL TO CEILING CORNER

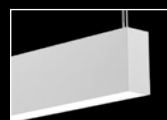

recessed
companion



suspended
companion

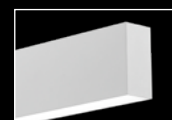

wall mount
companion

DIMENSIONAL DATA

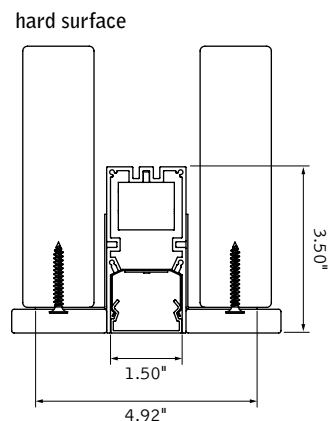
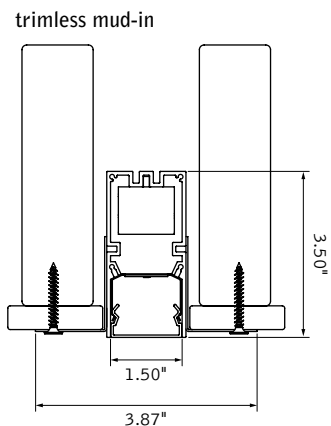

Designed for 2"x6" construction
Note: 0.375" min - 1.625" max surface thickness
Consult factory for thicker surfaces.

FEATURES

Narrow extruded aluminum 1.5" recessed linear slot LED that transitions from wall to ceiling.

Individual units and continuous runs in 1" increments.

Frosted acrylic lens provides uninterrupted illumination, without pixels or shadows.

LED position and lens material optimized to provide the perfect blend of high performance and visual comfort.

Choice of output levels to meet a wide variety of application needs.

PERFORMANCE

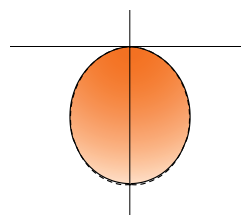

4' Flush Lens
625 Lumens per foot

Delivered Lumens: 2500lm

Total System Watts: 24W

PRODUCT OVERVIEW

Lumen Output:	500-2500lm
Wattage:	6-24W
LPW:	89-122
SDCM:	3

Photometric performance is measured in accordance with IESNA LM-79.
Visit focalpointlights.com for complete photometric data.

MOUNTING INFORMATION

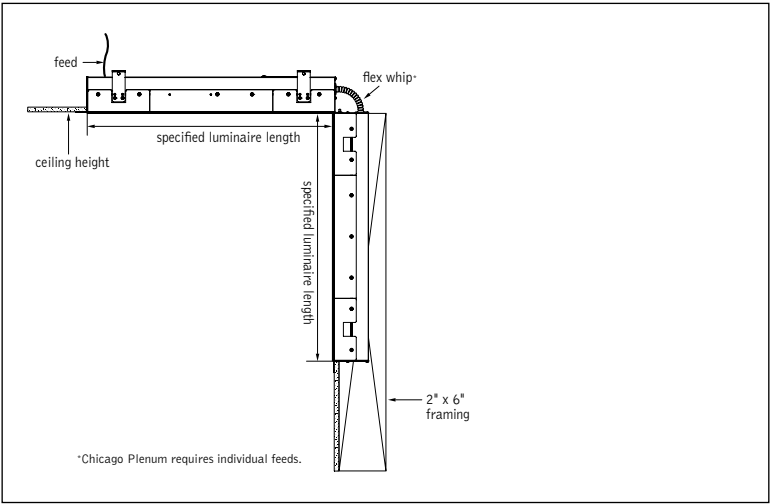

SPECIFICATIONS

LED System

Proprietary linear LED module incorporates premium LEDs on a robust platform to achieve excellent thermal management. LEDs are placed to promote a uniform appearance. Available in 3000K, 3500K or 4000K with both 80 and 90 CRI options. LED modules and drivers are replaceable from below. Color accuracy <3 SDCM.

Construction

One piece extruded aluminum housing. 20 Ga. steel end caps. Housing for new construction applications. XFW acceptable for use with wood, consult factory for Type IC availability. 8' unit weight: 15lbs.

Optic

Reflectors fabricated of 22 Ga. steel finished in High Reflectance White powder coat. Extruded acrylic lens .07" thick with frosted finish, up to 8' continuous.

Electrical

Luminaires are pre-wired with factory installed branch circuit wiring and over-molded quick connects. Standard 120-277V constant current driver includes 0-10V analog dimming. Power factor > .9.

Emergency Battery

Emergency output - 10 watts for 90 minutes. See EM/EC Guide for default locations and ordering details.

Labels

UL and cUL listed. Suitable for Dry or Damp Locations, indoor use only.

Finish

Polyester powder coat applied over a multi-stage pre-treatment.

Lumen Maintenance

Reported: L70 at >61,000 hours
L90 at >61,000 hours

Calculated: L70 at 470,000 hours
L90 at 115,000 hours

Derived from EPA TM-21 calculator. Based on typical conditions, consult factory for additional data.

Reliability

At Focal Point, our products are designed to stand the test of time. Each luminaire is engineered using superior components, manufactured with the utmost care and rigorously tested. Contact us for reliability data.

Warranty

LED system rated for operation in ambient environments up to 25°C. 5-year limited warranty.

4' PERFORMANCE CHART

Shielding	Lumens per Foot	Delivered Lumens	Tested System Watts	LPW
Flush Lens	125LF	500	6	89
	250LF	1000	9	110
	375LF	1500	13	119
	500LF	2000	16	121
	625LF	2500	20	122

Based on 3500K, 4' lengths. Lumen Multipliers: 90 CRI = 0.87. Lumen output may vary +/- 5%. Actual wattage may vary +/- 5%

ORDERING

Luminaire Series		FSM1
Seem 1 LED	FSM1	
Shielding		FL
Flush Lens	FL	
Lumen Output		
125 Lumens per foot <small>(4' minimum length. Consult factory for Lutron, DALI)</small>	125LF	
250 Lumens per foot <small>(3' minimum length)</small>	250LF	
375 Lumens per foot	375LF	
500 Lumens per foot	500LF	
625 Lumens per foot	625LF	
Color Temperature		
3000K, 80CRI or 90CRI	30K or 930K	
3500K, 80CRI or 90CRI	35K or 935K	
4000K, 80CRI or 90CRI	40K or 940K	
Circuit		1C
Single Circuit	1C	
Voltage		
120/277 UNV Volt	UNV	
347 Volt <small>(LD1 driver only)</small>	347	
Control System & Dimming Level		
0-10V - 10% Dimming	LD1	
0-10V - 1% Dimming	L11	
Lutron Hi-Lume EcoSystem (LDE1) - 1% Dimming	LH1	
DALI 1% Dimming	D11	
Ceiling Configuration		
Wall to Ceiling corner, Mud-in Trimless	CXFF	
Wall to Ceiling corner, Hard Surface, Non-Drywall	CXFN	
Wall to Ceiling corner, Wood	CXFW	
Factory Options		
Chicago Plenum	CP	
Emergency Circuit	_EC	
Emergency Battery Pack <small>(4' minimum length. See EM/EC Guide for default locations and ordering details.)</small>	_EM	
6' New York City Flex Whip (120V)	FN1	
6' New York City Flex Whip (277V)	FN2	
6' Flex Whip	FW	
Finish		WH
Matte White Housing	WH	
Luminaire Length <small>(Lengths are nominal)</small>		
Specify luminaire/row length in 1' increments <small>(2' minimum. Smaller increments available, consult factory) Example: 12C6W= 12' in Ceiling, 6' in Wall</small>	X'CX'W	