

mini-grazer™

FMG



⚠ ROUGH-IN SHELL MUST BE INSTALLED PRIOR TO CEILING ⚠

FOCAL POINT PARTS

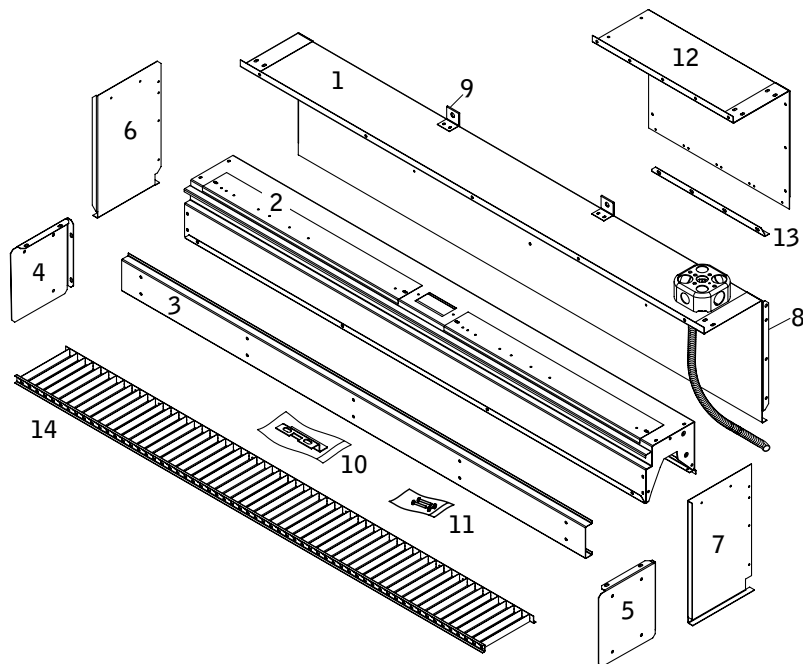

KEY



ATTENTION



GLOVES
REQUIRED



POWER OFF



POWER ON

PARTS LIST

1 ROUGH-IN SHELL	11 HARDWARE BAG
2 LIGHT MODULE	
3 WALL RAIL	OPTIONAL
4 FINISH END, RIGHT	12 SLIDING SLEEVE
5 FINISH END, LEFT	13 FINISH FLANGE
6 FLANGE END, RIGHT	14 LOUVER
7 FLANGE END, LEFT	
8 JOINER BRACKET	
9 MOUNTING BRACKET	
10 LOCKING BRACKET (SHIPPED ATTACHED TO END OF LIGHT MODULE)	

ROUGH-IN SHELL TYPES (4' SHOWN)

(JOINER BRACKET LOCATION DETERMINES SHELL TYPE)

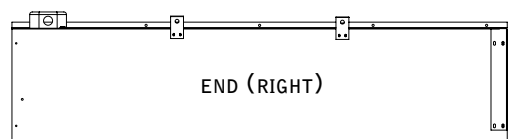
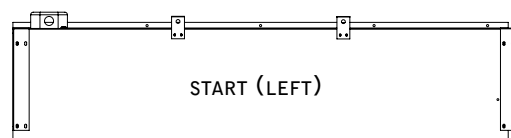
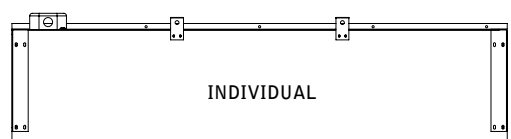

J-BOX LOCATIONS

(ALL SHELLS COMES WITH J-BOX INSTALLED)

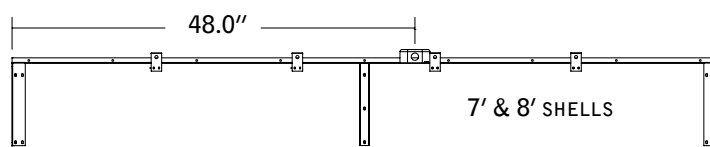
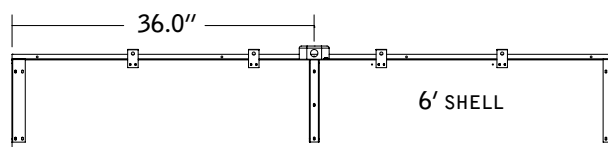
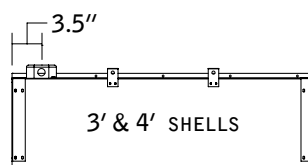

Luminaires must be installed by a qualified electrician (check with local and national codes for proper installation).
To prevent electrical shock, disconnect electrical supply before installation or servicing.

WALL/CEILING PREP

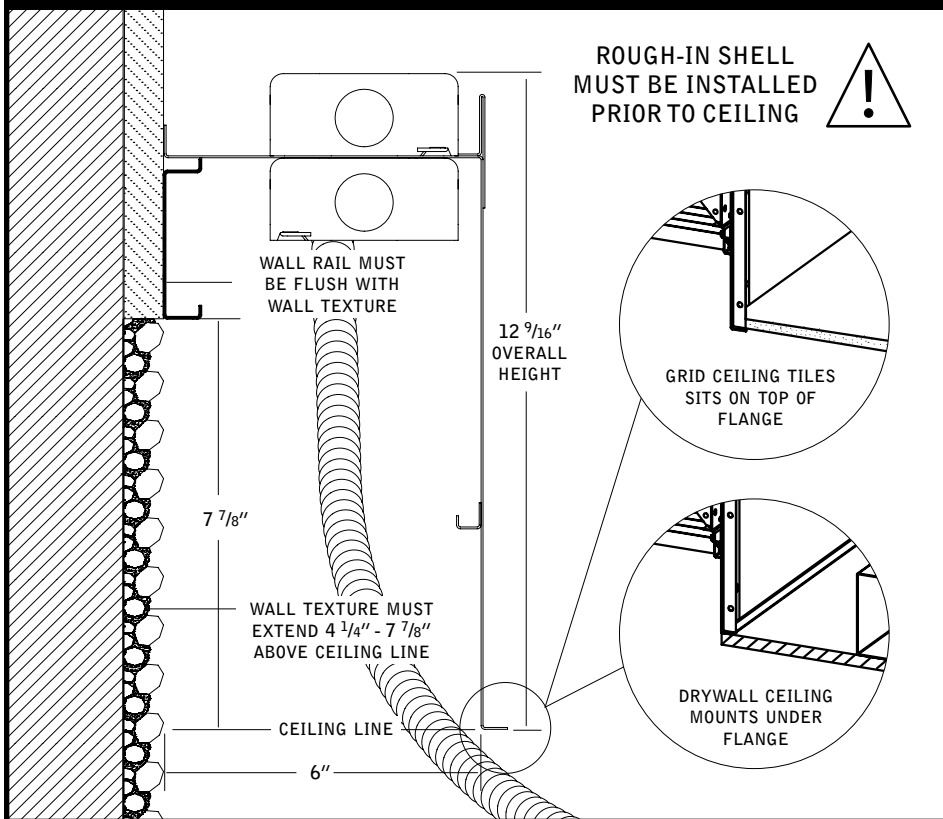

ENDS TERMINATING AT WALL

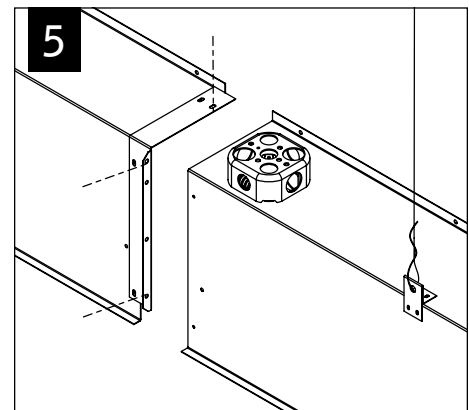
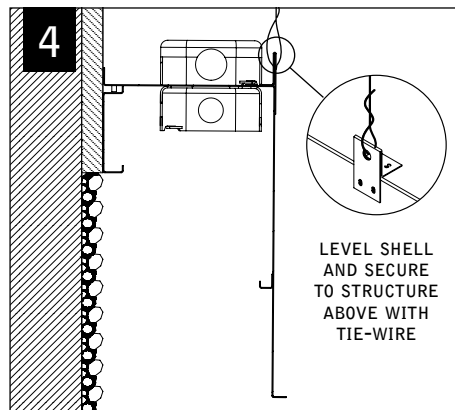
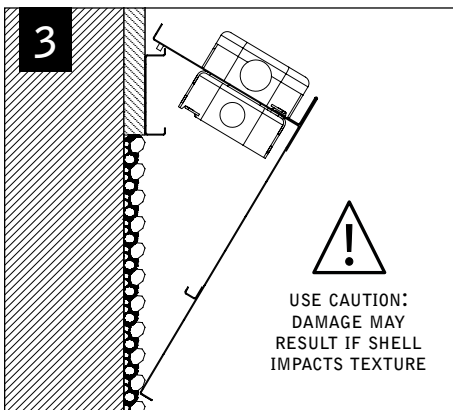
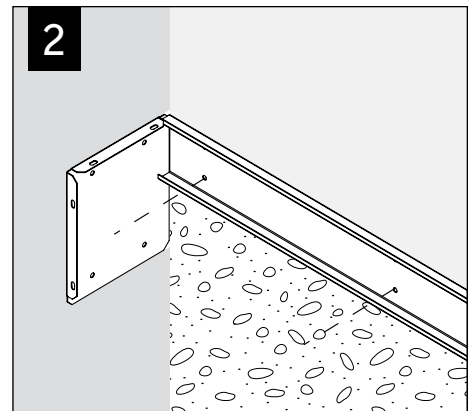
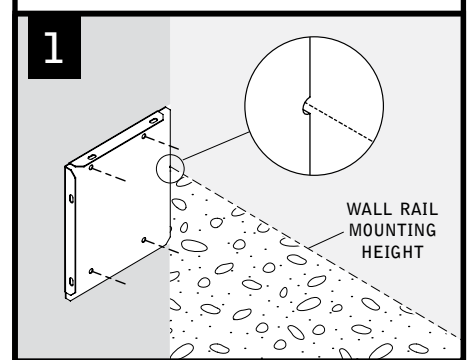

REPEAT STEPS 3 - 5 FOR ALL INTERMEDIATE SHELLS

SLIDING SLEEVE - OPTIONAL

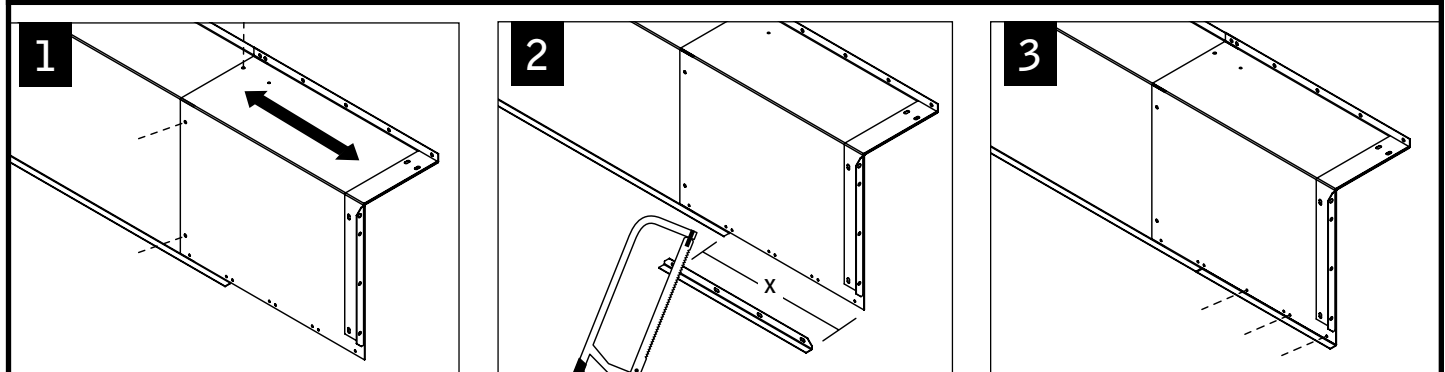

Luminaires must be installed by a qualified electrician (check with local and national codes for proper installation).
To prevent electrical shock, disconnect electrical supply before installation or servicing.

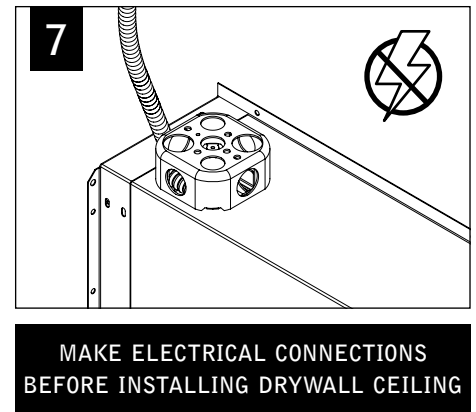
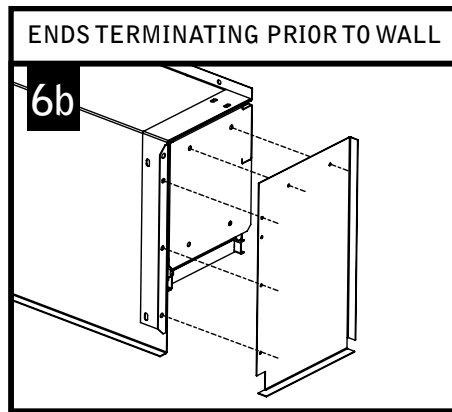
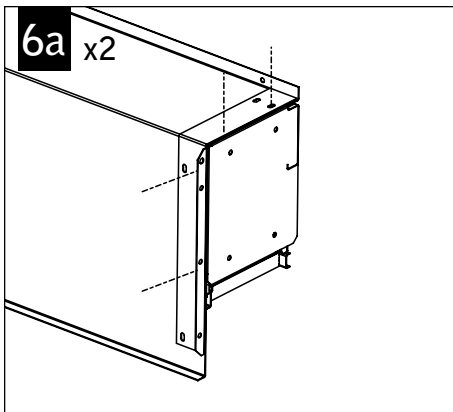

LIGHT MODULE INSTALLATION

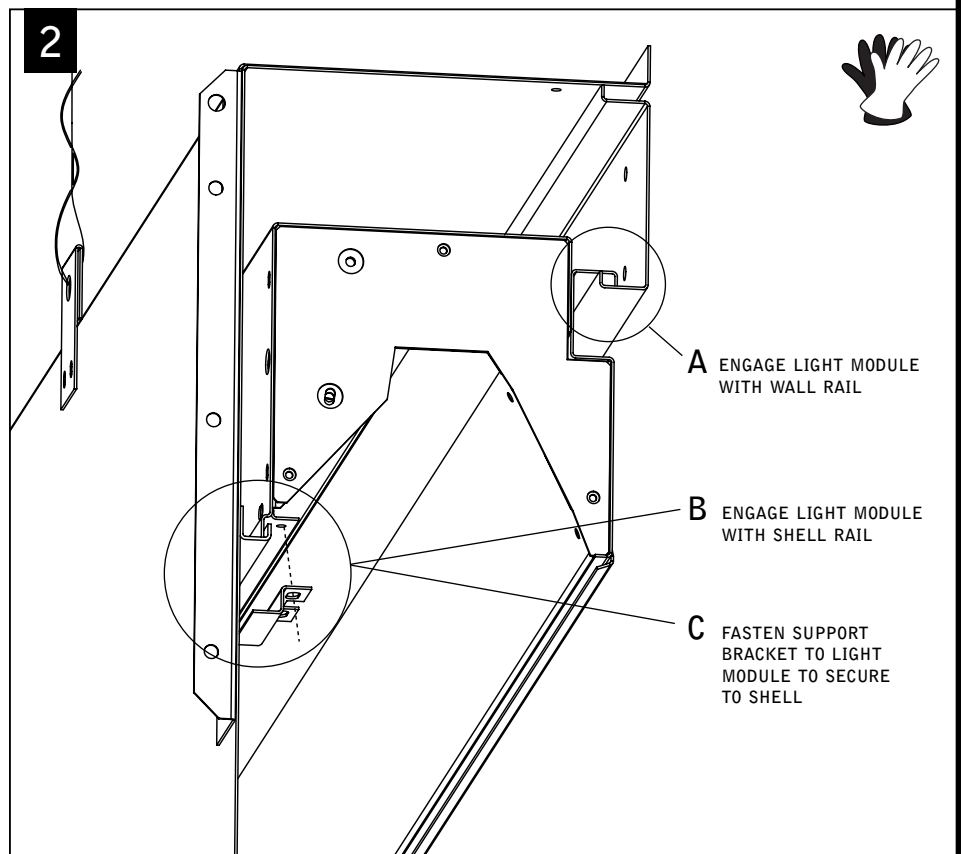
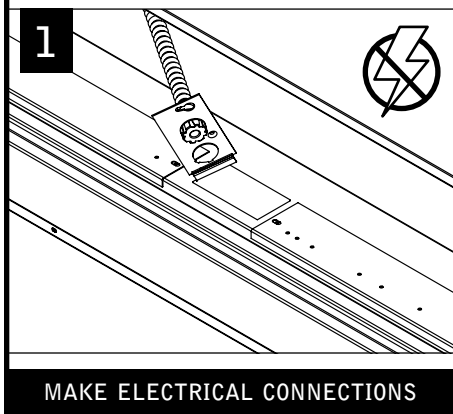

LAMPING

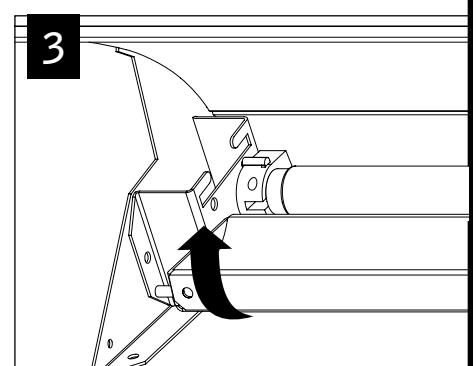
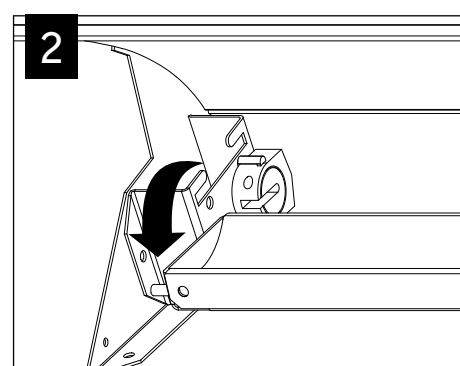
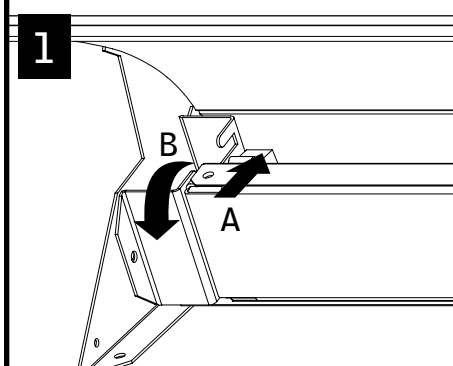

Luminaires must be installed by a qualified electrician (check with local and national codes for proper installation).
To prevent electrical shock, disconnect electrical supply before installation or servicing.

LOUVER (OPTIONAL)

4

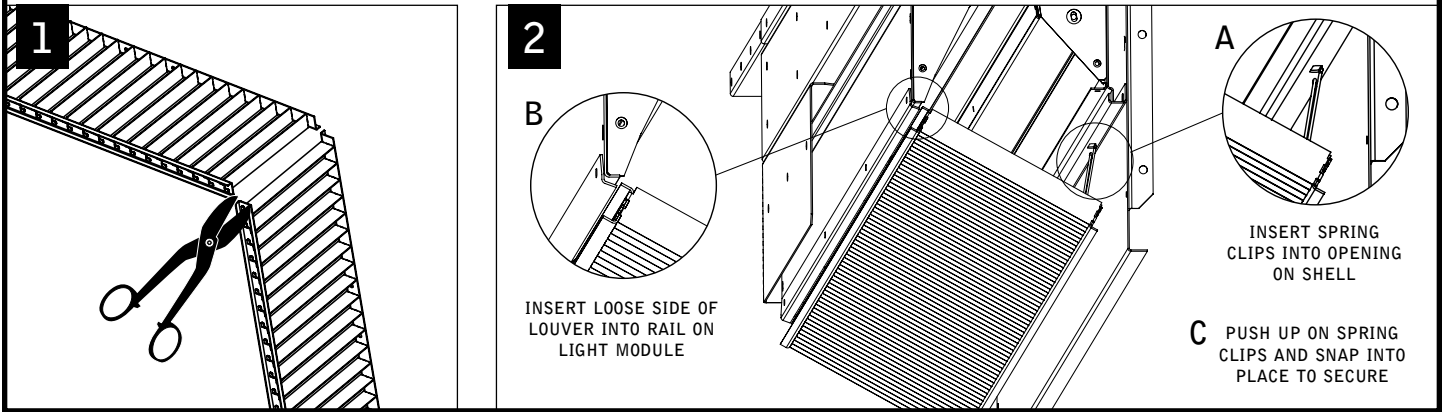

BALLAST SERVICE

4

- 1** PULL DOWN ON SHELL SIDE OF LOUVER TO DISENGAGE.
- 2** RELEASE SPRING CLIPS AND REMOVE LOUVER.
- 3** REMOVE SUPPORT BRACKETS TO RELEASE MODULE FROM SHELL.
- 4** REMOVE LIGHT MODULE FROM SHELL AND DISCONNECT ELECTRICAL.

