

id+ 4.5" & 6" round housing

FLC4D | FLC4W | FLC6D | FLC6W



FOCAL POINT®

! LUMINAIRE MUST BE INSTALLED PRIOR TO DRYWALL CEILING. ALL GRID LUMINAIRES MUST BE SECURED TO STRUCTURE ABOVE. !

NON-EMERGENCY - THERMALLY PROTECTED, NON-IC

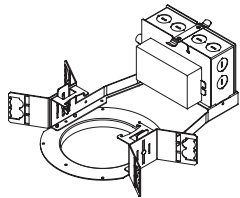

FLC4D | FLC4W

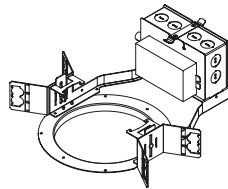

FLC6D | FLC6W

! OPTIONAL BAR HANGERS SOLD SEPARATELY

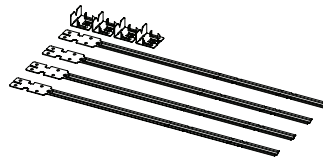

KEY



POWER OFF



POWER ON



LEVEL



ATTENTION



SEE ADDITIONAL INSTRUCTIONS

EMERGENCY - INTEGRAL TEST SWITCH

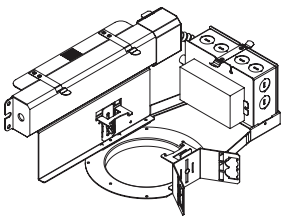

FLC4D | FLC4W

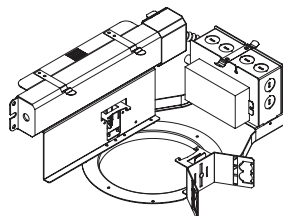

FLC6D | FLC6W

CP - EMERGENCY/NON-EMERGENCY

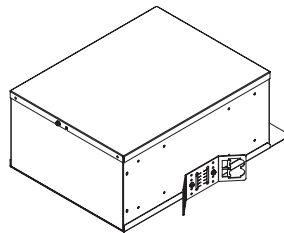

FLC4D | FLC4W | FLC6D | FLC6W

A

I

TO SET CEILING THICKNESS SEE FOCAL POINT INSTRUCTION SHEET IS0586

1				
	5 1/8"	7 3/4"	6 5/8"	9 5/8"
	4.5" overlap	4.5" flush	6" overlap	6" flush

GRID - 1/2" CONDUIT & CLIP (BY OTHERS)

2 x2		3		4 x4	
-------------	--	----------	--	-------------	--

Luminaires must be installed by a qualified electrician (check with local and national codes for proper installation). To prevent electrical shock, disconnect electrical supply before installation or servicing.

GRID - BAR HANGERS (SOLD SEPARATELY)

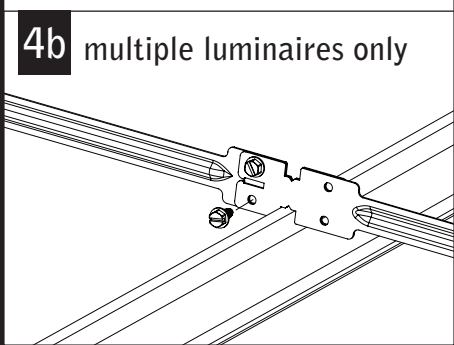
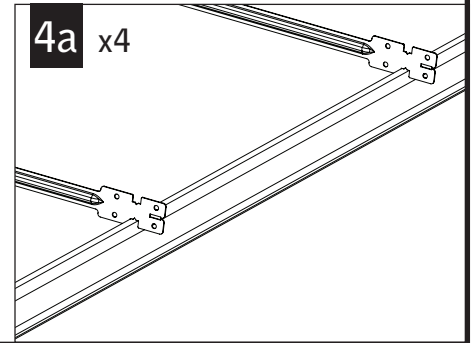
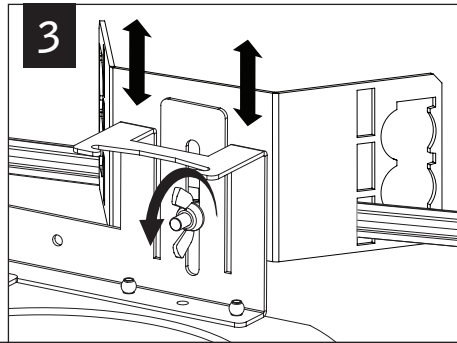
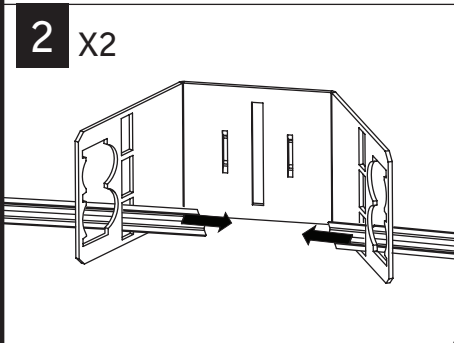

DRYWALL - BAR HANGERS

WOOD STUDS

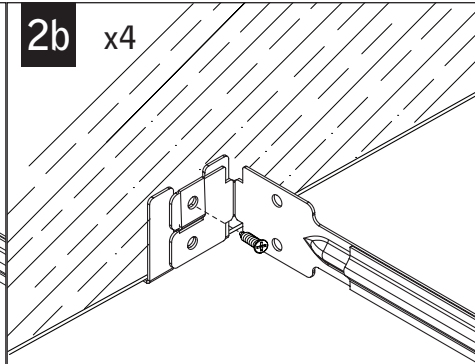
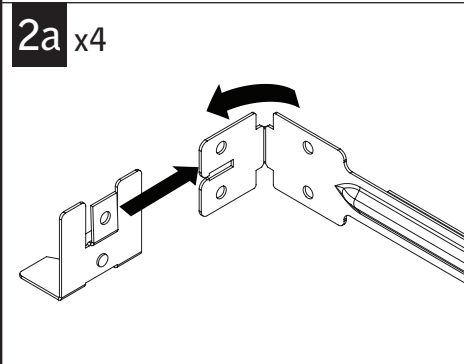

METAL STUDS

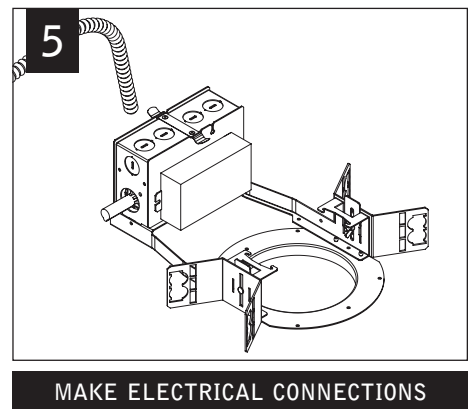
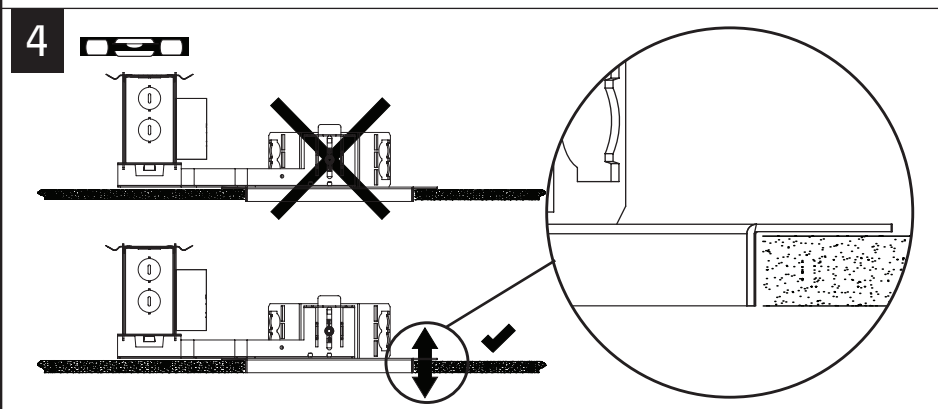
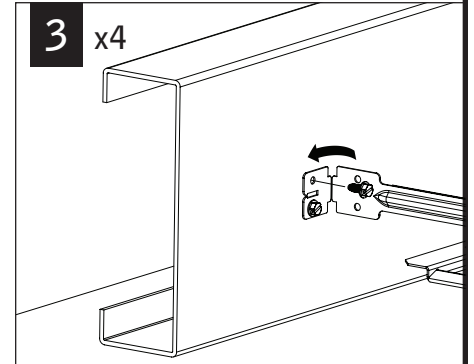

Fixtures must be installed by a qualified electrician (check with local and national codes for proper installation).
To prevent electrical shock, disconnect electrical supply before installation or servicing.

FLUSH TRIM MUD-IN

1

4.5"
7 3/4"

6"
9 5/8"

⚠️ 1" MAX. CEILING THICKNESS

2 ⚠️ DO NOT REMOVE DUST COVER UNTIL TAPE AND MUD-IN COMPLETE

MUD CASTING WILL BE SLIGHTLY RECESSED WHEN BAR HANGERS ARE PROPERLY POSITIONED.

3 X4 ADJUST JACK SCREWS TO LEVEL MUD CASTING TO CEILING

EMERGENCY - INTEGRAL TEST SWITCH

A

BATTERY UNIT CONNECTOR INSIDE

CP HOUSING

B **I**

SEE BATTERY MANUFACTURER INSTRUCTIONS

EMERGENCY MAXIMUM MOUNTING HEIGHT:

DOWNLIGHT TRIM: 23.00'

WALL WASH TRIM: 19.00'

C **I**

FOR EMERGENCY INTEGRAL TEST SWITCH INSTALLATION SEE FOCAL POINT INSTRUCTION SHEET IS0586

⚠️

DO NOT MATE CONNECTOR UNTIL INSTALLATION IS COMPLETE AND A.C. POWER IS SUPPLIED

DRIVER SERVICE

1

Contractor is responsible for adequately reinforcing walls and/or ceilings to support fixture weight. Focal Point, LLC accepts no responsibility for inadequately reinforced walls and/or ceilings. The information contained in this drawing is the sole property of Focal Point, LLC. Any reproduction in part or whole without the written permission of Focal Point, LLC is prohibited.