

! CONFIGURATIONS ARE RUN SPECIFIC, PLEASE CONSULT FACTORY DRAWINGS BEFORE BEGINNING INSTALLATION. !

FOCAL POINT

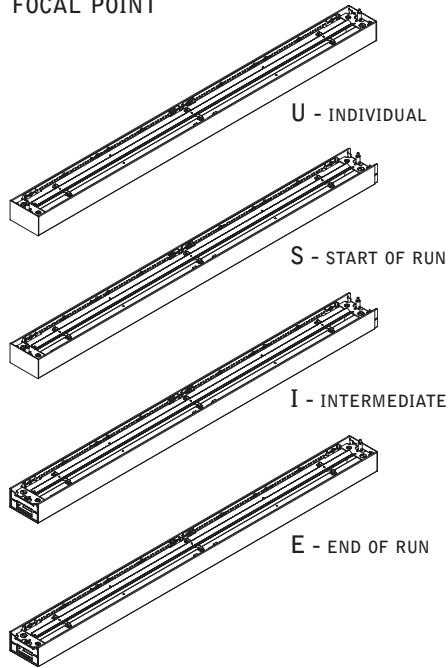

KEY



POWER OFF



ATTENTION



POWER ON



LEVEL



SEE ADDITIONAL INSTRUCTIONS

! INDIVIDUAL INSTALLATIONS FOLLOW STEPS 1, 2, 6, 7

1

FOLLOW FOCAL POINT INSTRUCTIONS FOR UNIVERSAL SUSPENSION SYSTEM ASSEMBLY.

SEE IS0166



2

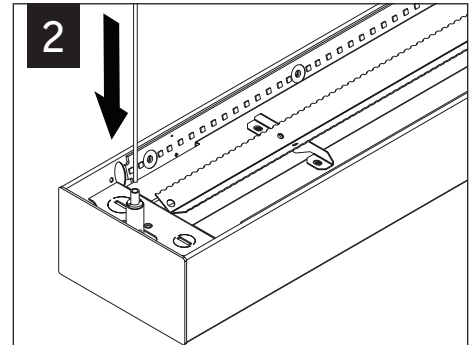

! AVOID ALL CONTACT WITH LED SURFACE, LEDs ARE EASILY DAMAGED!

3

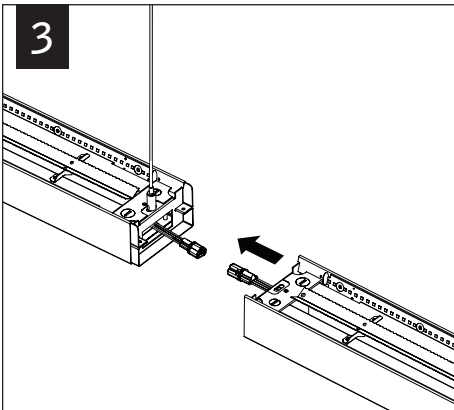

4

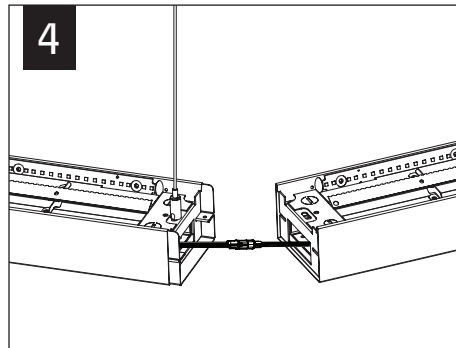

MAKE ELECTRICAL CONNECTIONS

5

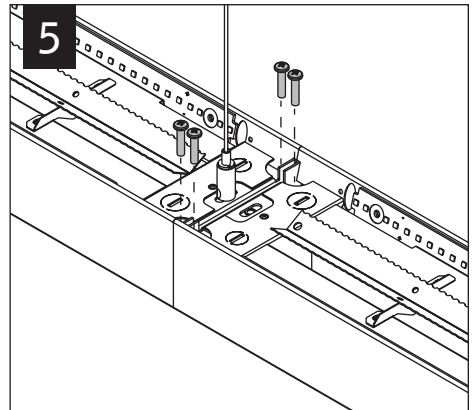

6

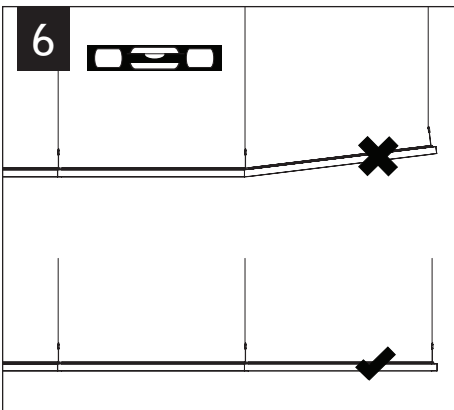

7

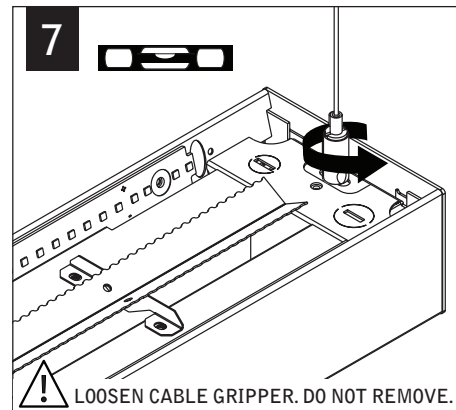

! LOOSEN CABLE GRIPPER. DO NOT REMOVE.

8

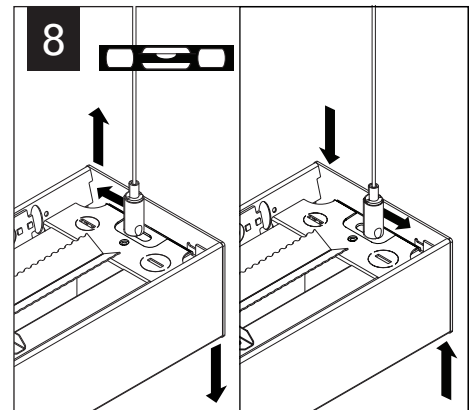

Luminaires must be installed by a qualified electrician (check with local and national codes for proper installation). To prevent electrical shock, disconnect electrical supply before installation or servicing.

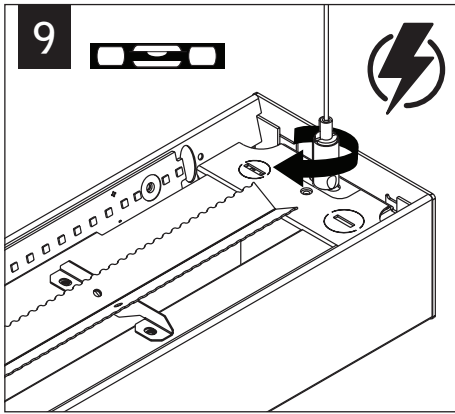

DRIVER SERVICE

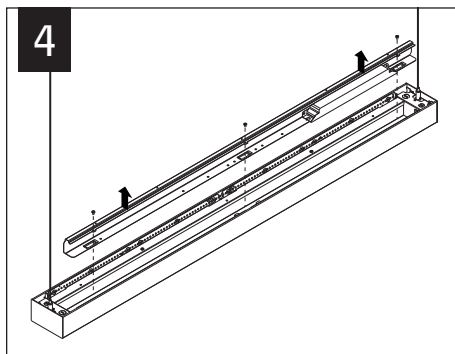
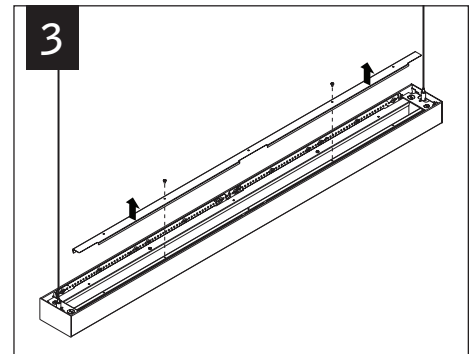
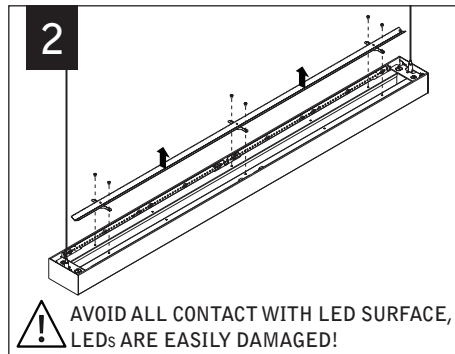
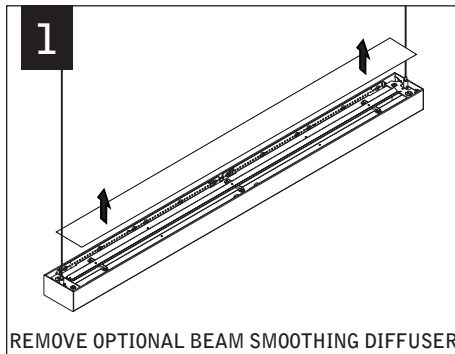

EMERGENCY



SEE BATTERY MANUFACTURER INSTRUCTIONS

EMERGENCY MAXIMUM MOUNTING HEIGHT:
7.50'

Contractor is responsible for adequately reinforcing walls and/or ceilings to support luminaire weight. Focal Point, LLC accepts no responsibility for inadequately reinforced walls and/or ceilings. The information contained in this drawing is the sole property of Focal Point, LLC. Any reproduction in part or whole without the written permission of Focal Point, LLC is prohibited. Covered by US Patents: D645,192 S & D645,193 S. Covered by European Patent: (D)00170300.