

# Facetta

FCT

CONNECTED<sup>TM</sup>  
SOLUTIONS

PL Preferred Light  
Experience BETTER COLOR

FOCAL POINT<sup>®</sup>

**⚠ AVOID ALL CONTACT WITH LED SURFACE, LEDs ARE EASILY DAMAGED!**

FOCAL POINT

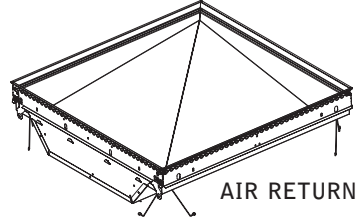
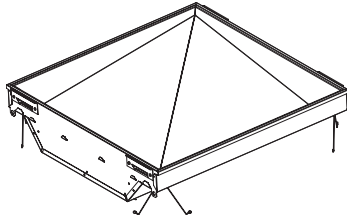

AIR RETURN

KEY



POWER OFF



POWER ON



ATTENTION

## GRID

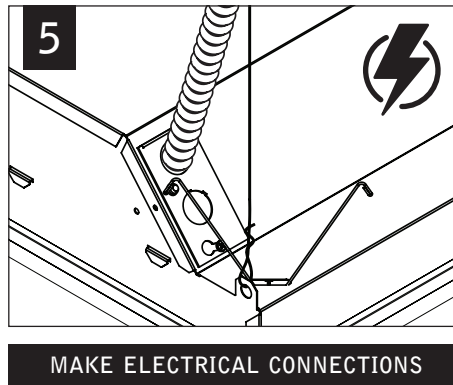
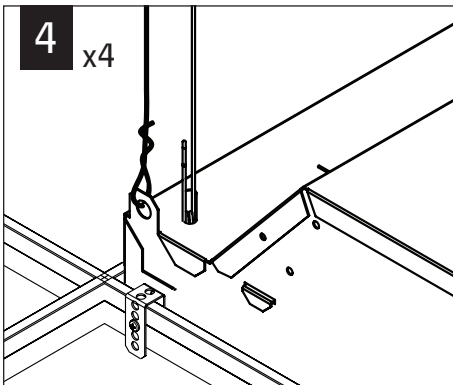
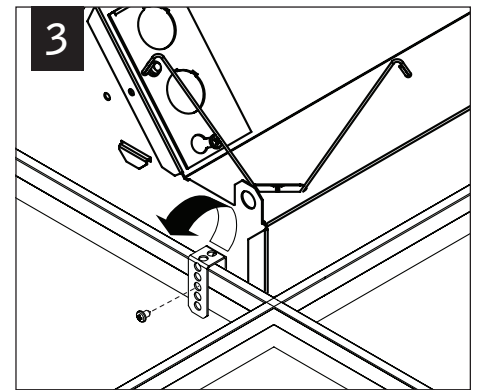
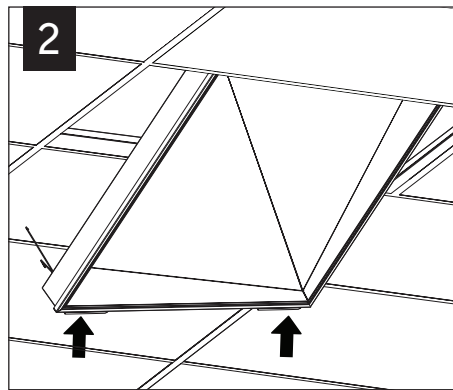
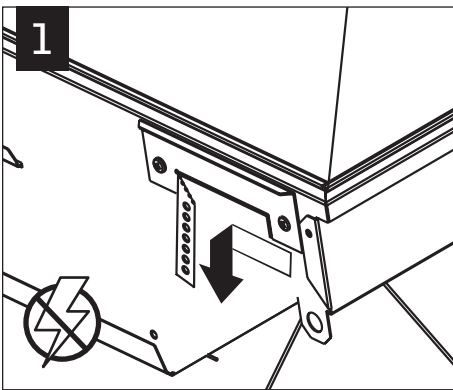

MAKE ELECTRICAL CONNECTIONS

## DRYWALL INSTALLATION

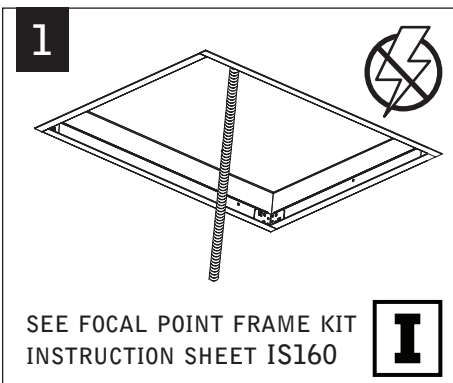

SEE FOCAL POINT FRAME KIT  
INSTRUCTION SHEET IS160

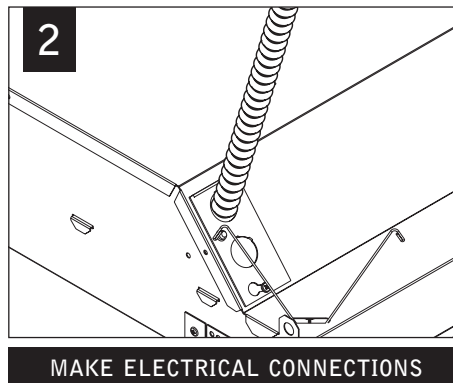

MAKE ELECTRICAL CONNECTIONS

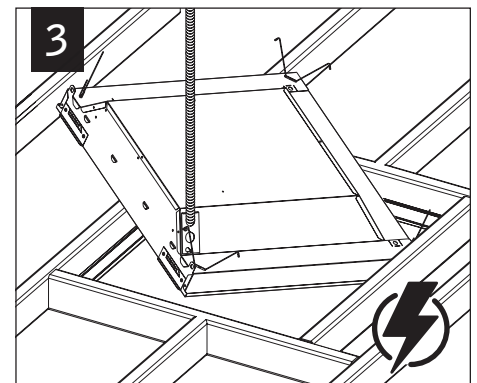

Luminaires must be installed by a qualified electrician (check with local and national codes for proper installation).  
To prevent electrical shock, disconnect electrical supply before installation or servicing.

## DRIVER SERVICE

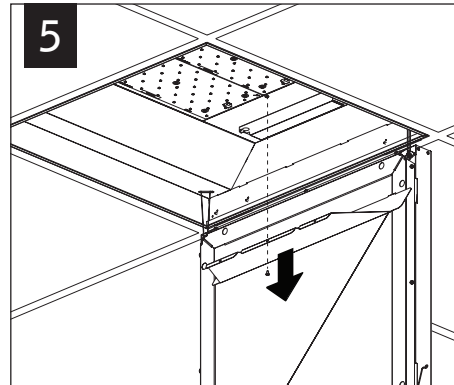
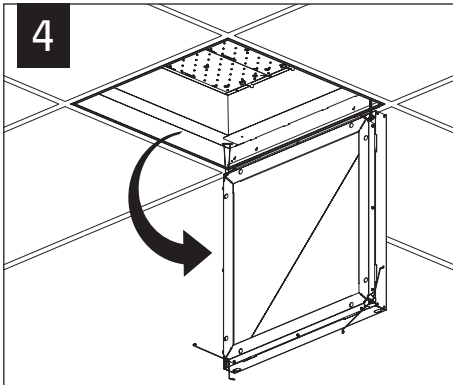
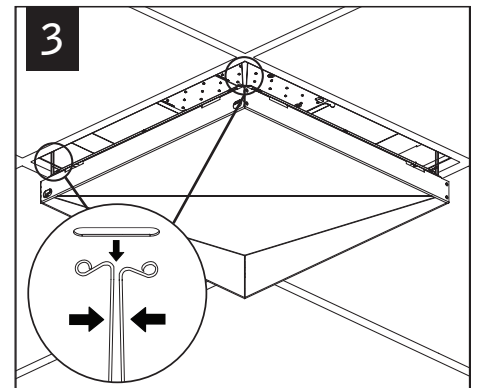
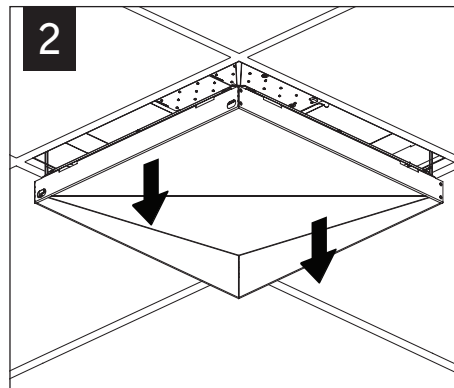
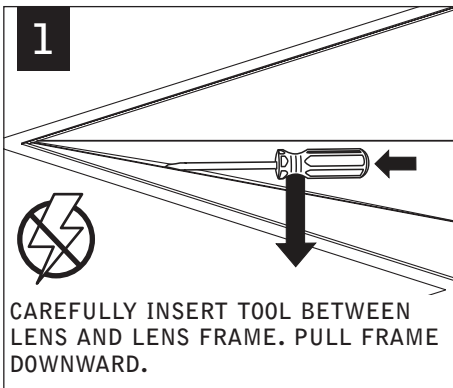

## AIR RETURN INSTALLATION

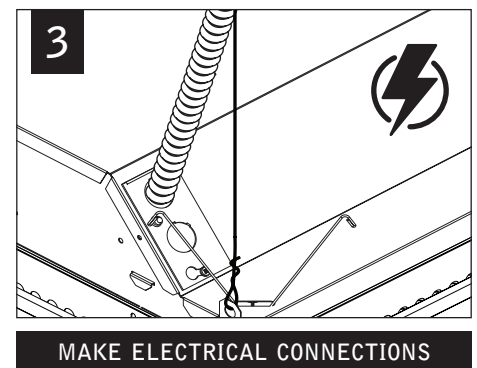
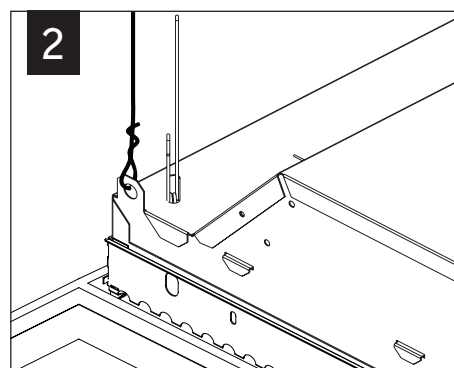
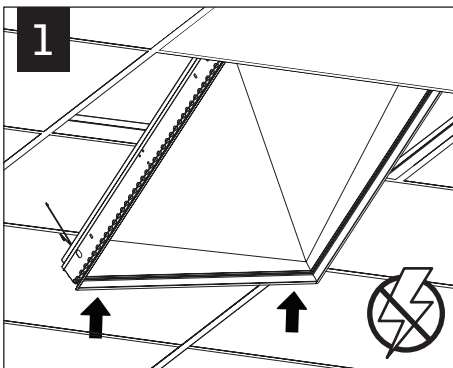

## ENLIGHTED

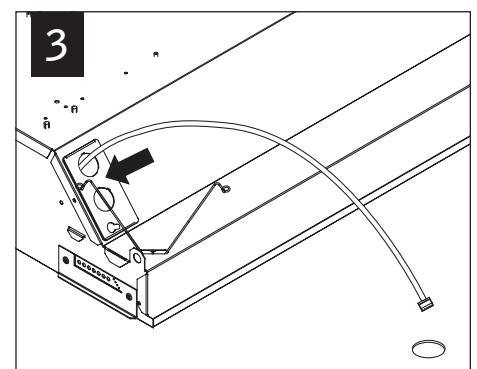
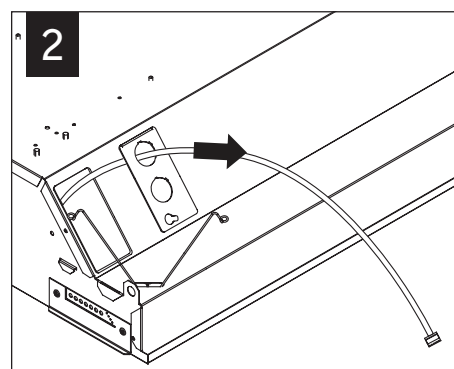
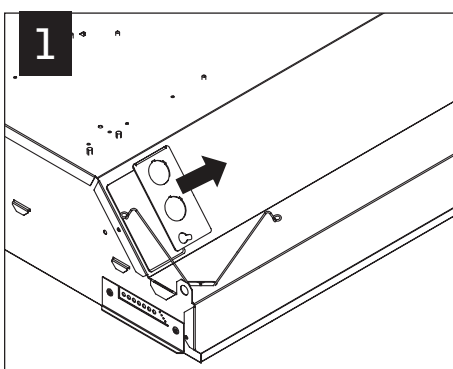

Luminaires must be installed by a qualified electrician (check with local and national codes for proper installation).  
To prevent electrical shock, disconnect electrical supply before installation or servicing.

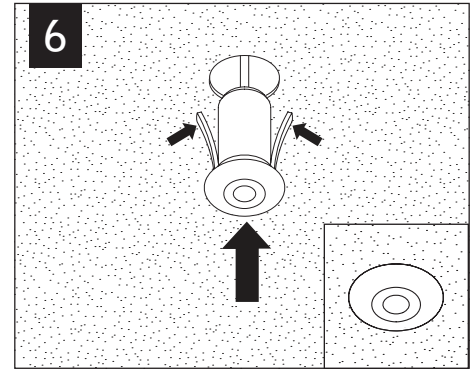
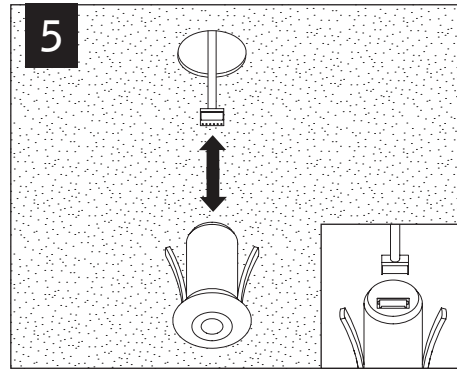
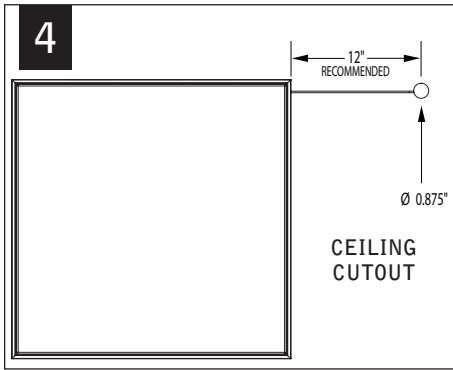

### ACUITY nLIGHT

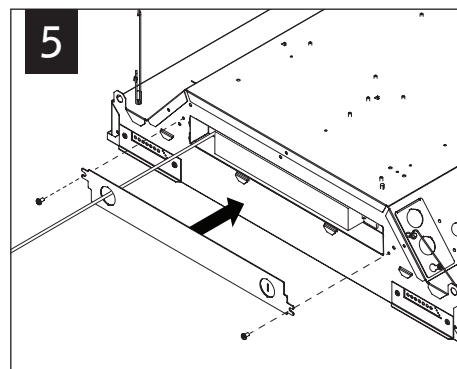
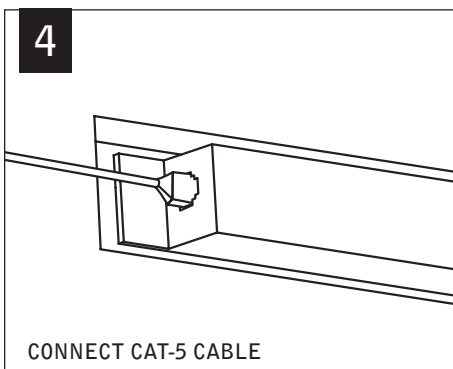
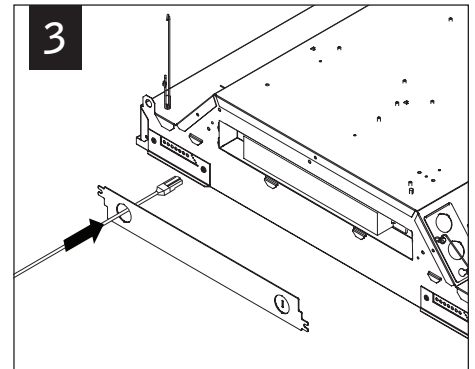
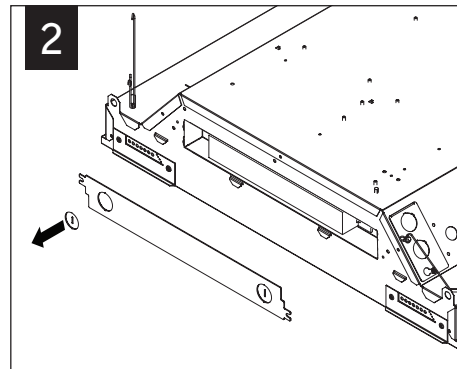
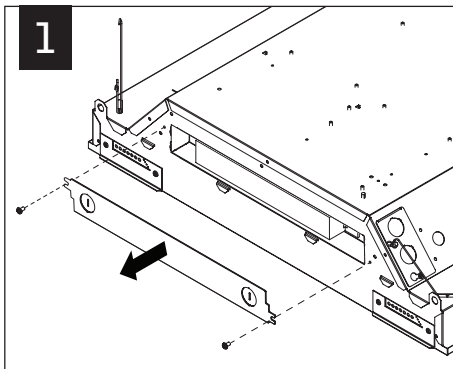

### WATTSTOPPER

