

SUSPENDED FAVCS

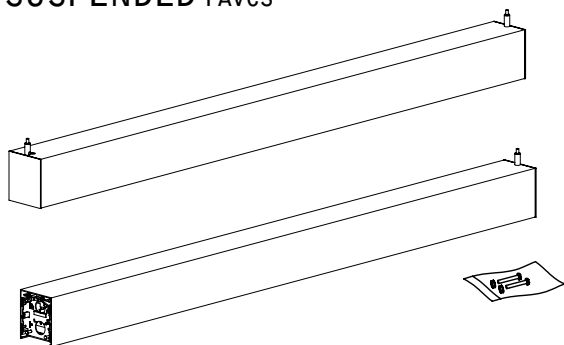

U- INDIVIDUAL
S- START OF RUN

I- INTERMEDIATE
E- END OF RUN

UNIVERSAL SUSPENSION SYSTEM - SHIPS SEPARATELY

SURFACE MOUNT FAVCS-SM

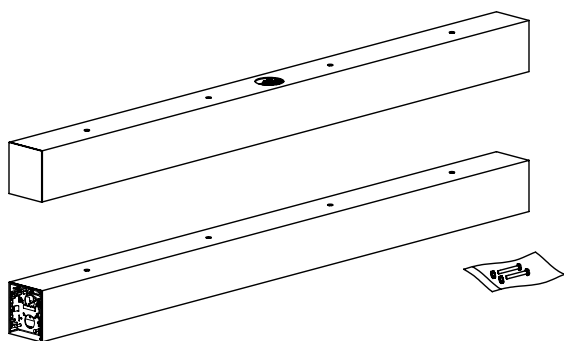

U- INDIVIDUAL
S- START OF RUN

I- INTERMEDIATE
E- END OF RUN



USE SINGLE DEVICE COVER OR SINGLE GANG HANDY BOX (BY OTHERS)
MOUNTING HARDWARE (BY OTHERS)

WALL MOUNT FAVCW

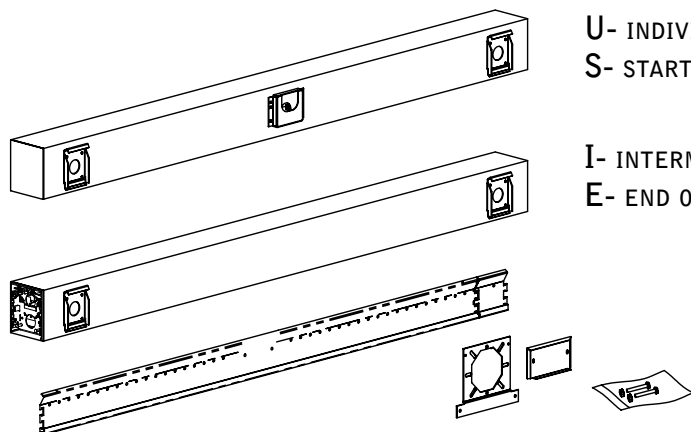

U- INDIVIDUAL
S- START OF RUN

I- INTERMEDIATE
E- END OF RUN

J-BOX (BY OTHERS)

KEY



POWER OFF



POWER ON



ATTENTION



ADDITIONAL
INSTRUCTIONS



LEVEL

WEIGHTS

FAVCS

4' - 9LBS | 8' - 18LBS

FAVCW

4' - 13LBS | 8' - 26LBS

Luminaires must be installed by a qualified electrician (check with local and national codes for proper installation).
To prevent electrical shock, disconnect electrical supply before installation or servicing.

SUSPENDED (FAVCS)

1



FOLLOW FOCAL POINT
INSTRUCTIONS FOR
UNIVERSAL SUSPENSION
SYSTEM ASSEMBLY.
SEE IS0166

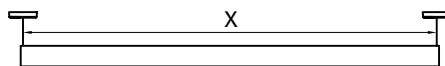

HOUSING/UNIT	X
4' INDIVIDUAL/START	47.5"
4' INTERMEDIATE/END	48.0"
8' INDIVIDUAL/START	95.5"
8' INTERMEDIATE/END	96.0"

2

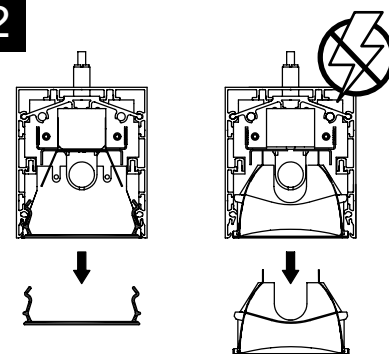

LENS ONLY

3

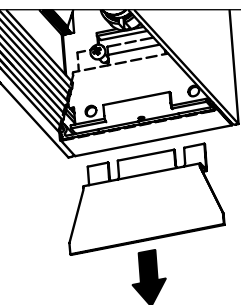

4

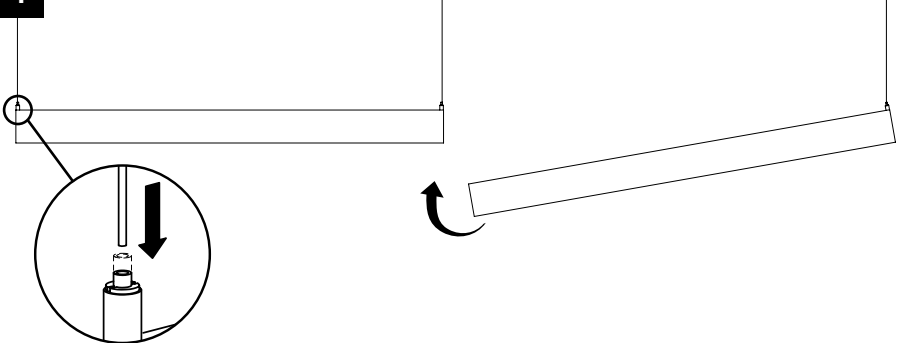

5

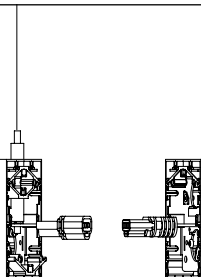

6

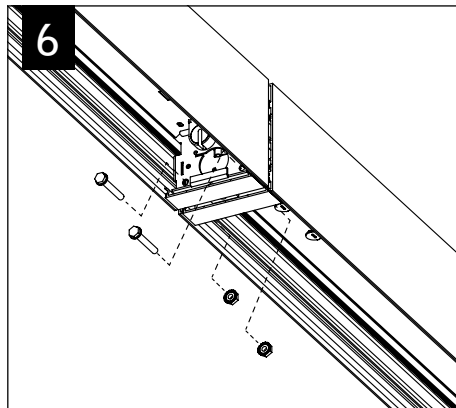

LENS ONLY

7

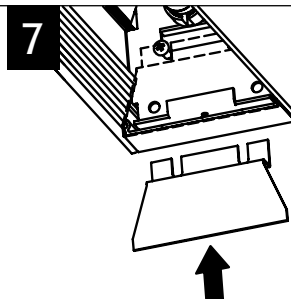

MAKE ELECTRICAL CONNECTIONS

8

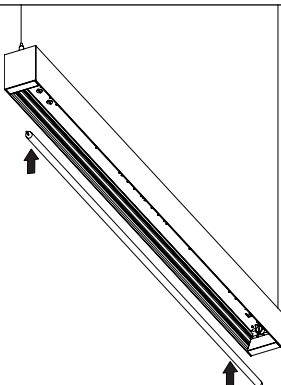

9

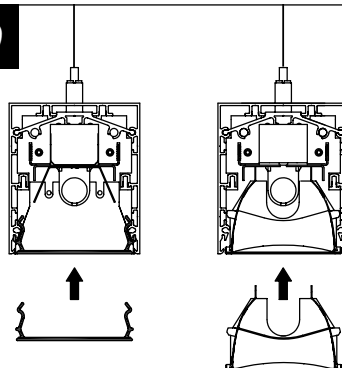

Luminaires must be installed by a qualified electrician (check with local and national codes for proper installation).
To prevent electrical shock, disconnect electrical supply before installation or servicing.

SURFACE MOUNT (FAVCS-SM)

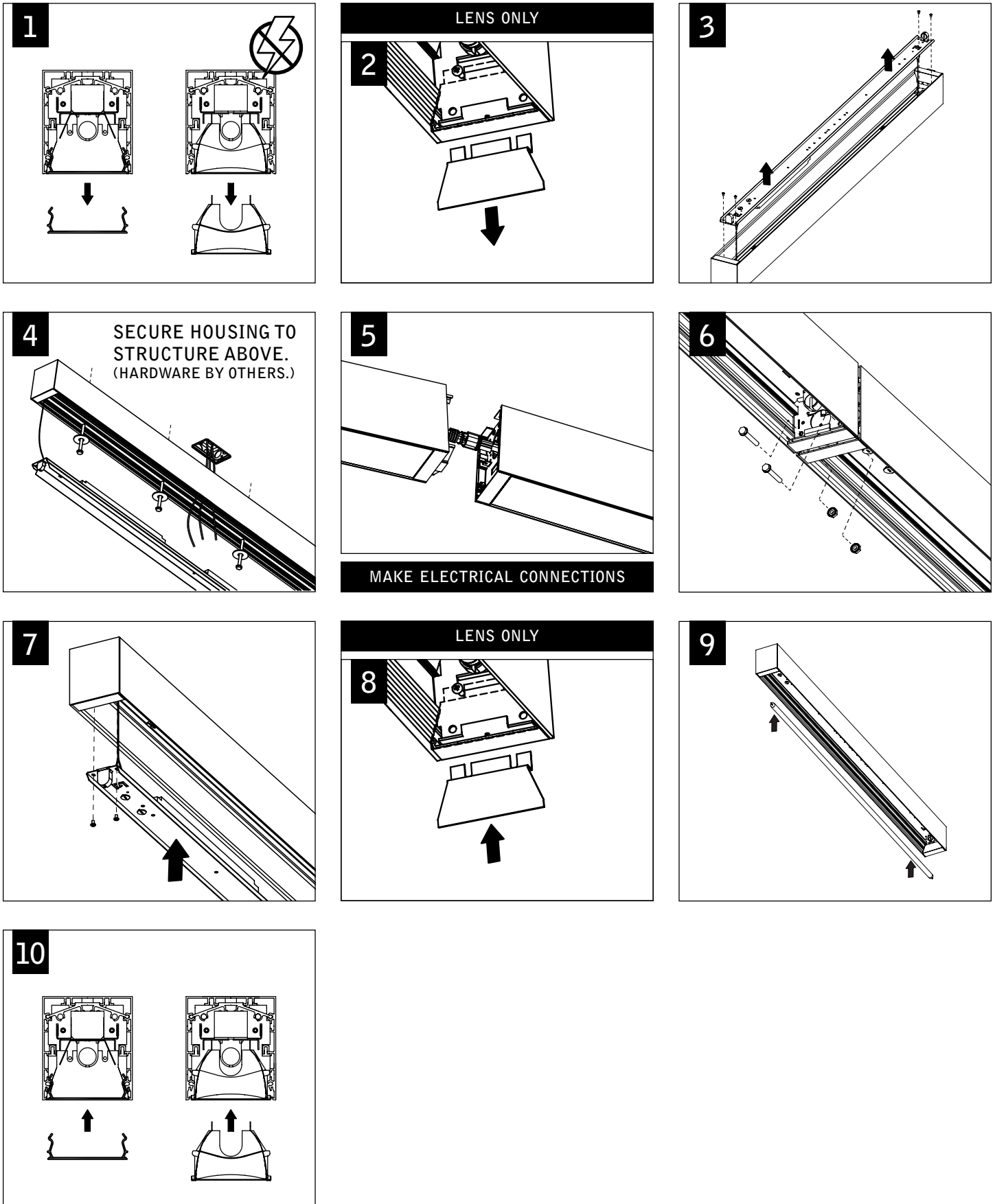

Luminaires must be installed by a qualified electrician (check with local and national codes for proper installation).
To prevent electrical shock, disconnect electrical supply before installation or servicing.

WALL MOUNT (FAVCW)

1

LOCATE J-BOX CENTER & INSTALL (J-BOX BY OTHERS)

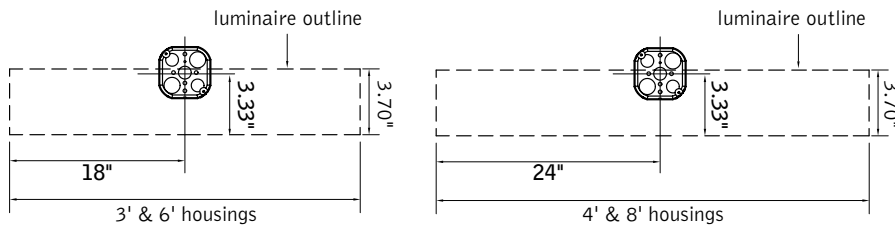

FEED LOCATIONS

2

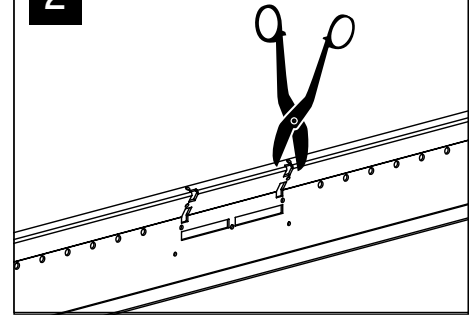

3

LOCATE MOUNTING RAIL

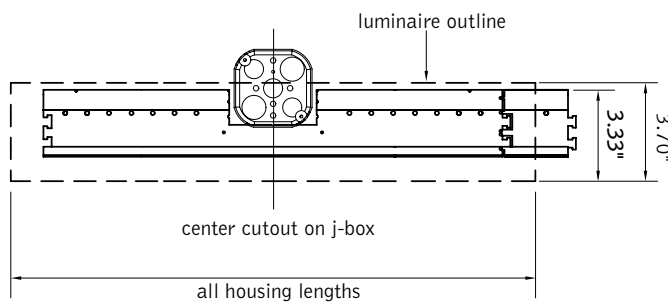

4

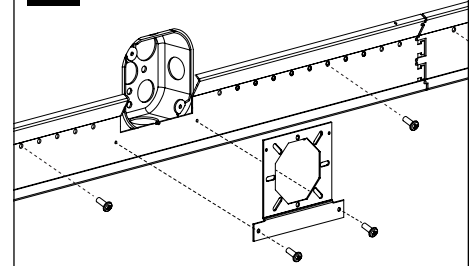

(FASTENERS BY OTHERS)

5

INSTALL REMAINING RAILS. REMOVE END SECTION FROM LAST RAIL IN RUN.

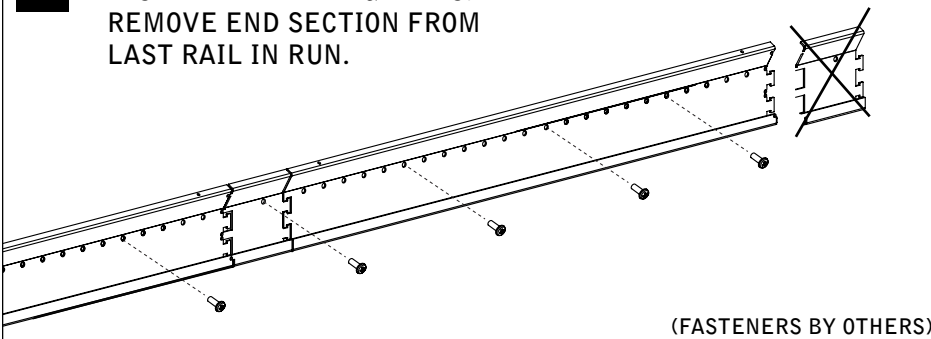

(FASTENERS BY OTHERS)

6

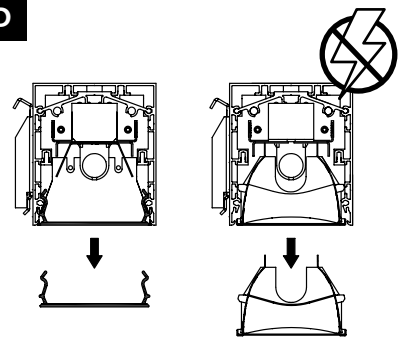

LENS ONLY

7

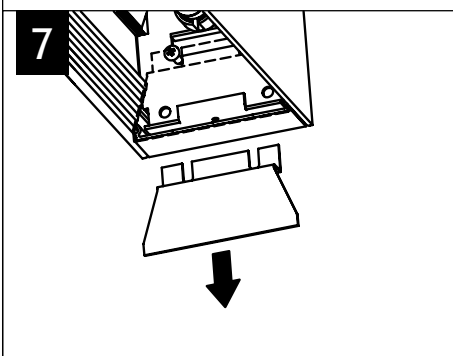

8

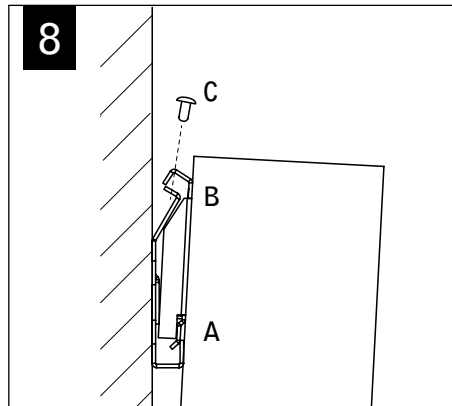

9

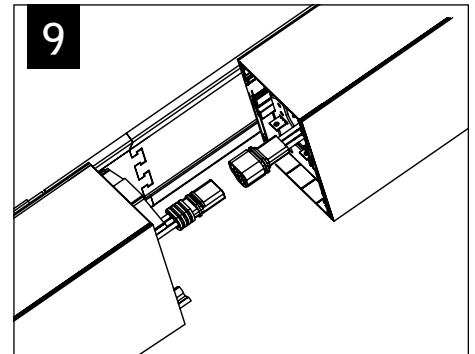

MAKE ELECTRICAL CONNECTIONS

Luminaires must be installed by a qualified electrician (check with local and national codes for proper installation).
To prevent electrical shock, disconnect electrical supply before installation or servicing.

WALL MOUNT (FAVCW) - CONTINUED

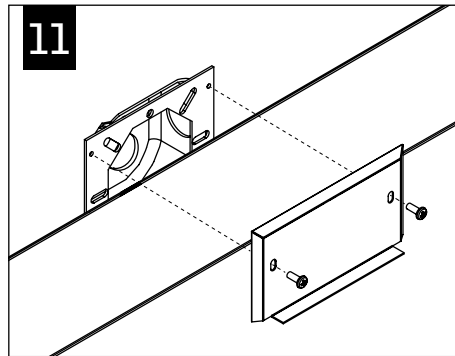
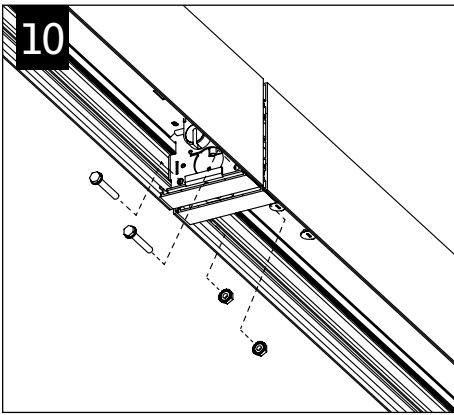

MAKE ELECTRICAL CONNECTIONS

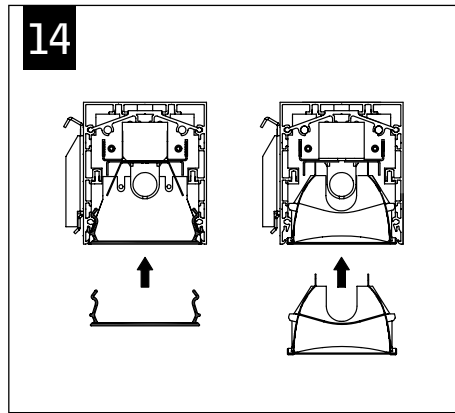
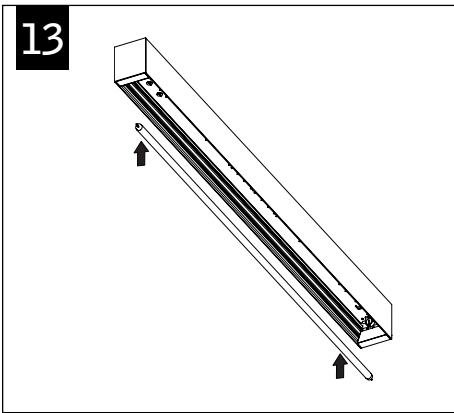
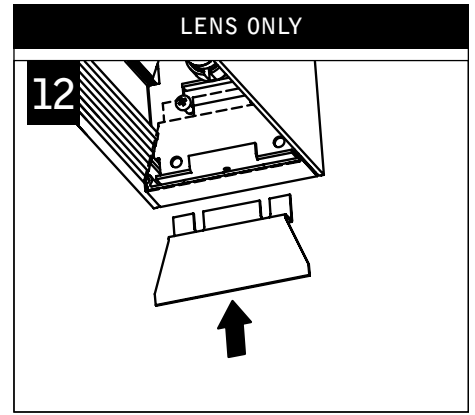

BALLAST SERVICE (SURFACE MOUNT SHOWN)

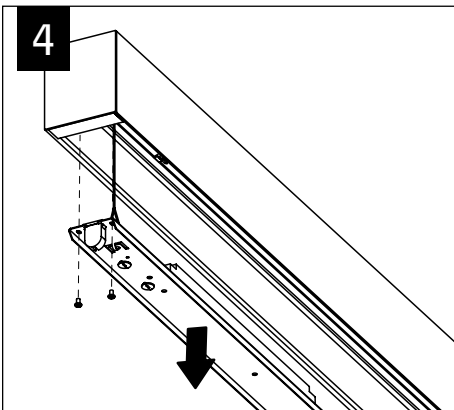
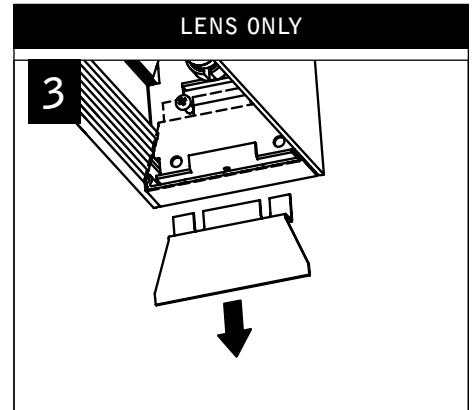
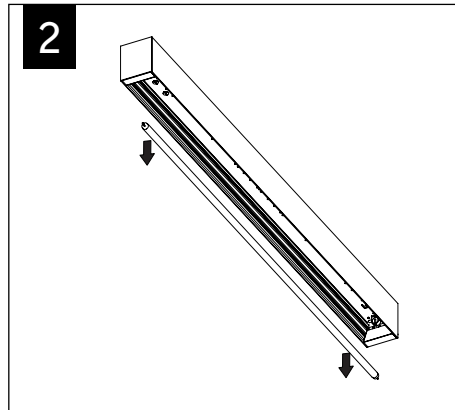
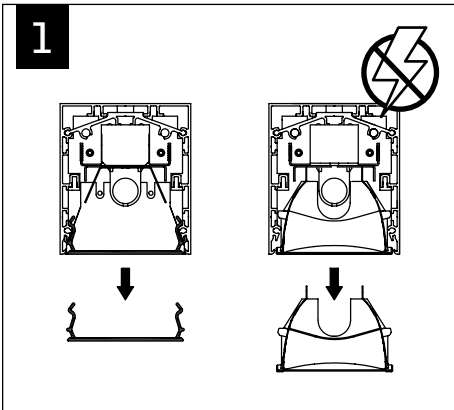

Contractor is responsible for adequately reinforcing walls and/or ceilings to support luminaire weight. Focal Point, LLC accepts no responsibility for inadequately reinforced walls and/or ceilings. The information contained in this drawing is the sole property of Focal Point, LLC. Any reproduction in part or whole without the written permission of Focal Point, LLC is prohibited.