

FS1 (SURFACE MOUNT)

SAFETY AND INSTALLATION INSTRUCTIONS

FIXTURES MUST BE INSTALLED BY A QUALIFIED ELECTRICIAN (CHECK WITH LOCAL AND NATIONAL CODES FOR PROPER INSTALLATION). TO PREVENT ELECTRICAL SHOCK, DISCONNECT ELECTRICAL SUPPLY BEFORE INSTALLATION OR SERVICING.

1. READ ALL INSTRUCTIONS PRIOR TO INSTALLATION.
2. DISCONNECT ELECTRICAL POWER BEFORE SERVICING LUMINAIRE.
3. TO AVOID DAMAGE, KEEP LUMINAIRE IN ORIGINAL CARTON.
4. DO NOT PLACE HEAVY OBJECTS ON CARTONS.

UNIT DESCRIPTION

FS1 (SURFACE MOUNT)

1X4

Dimensions: 6.5" H x 11.8" W x 48.0" L

Weight: 19 lbs

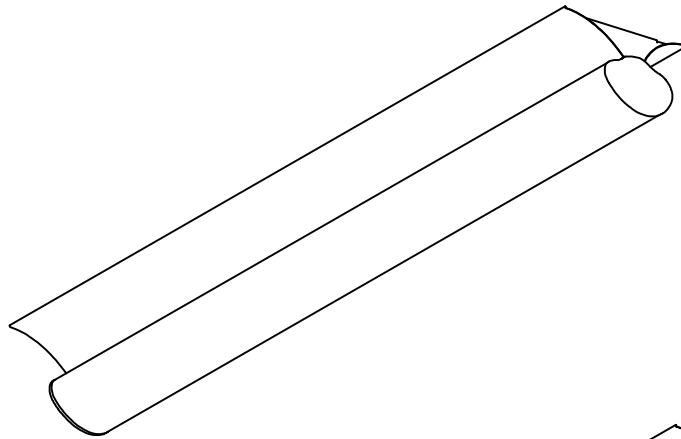

1X8

Dimensions: 6.5" H x 11.8" W x 96.0" L

Weight: 38 lbs

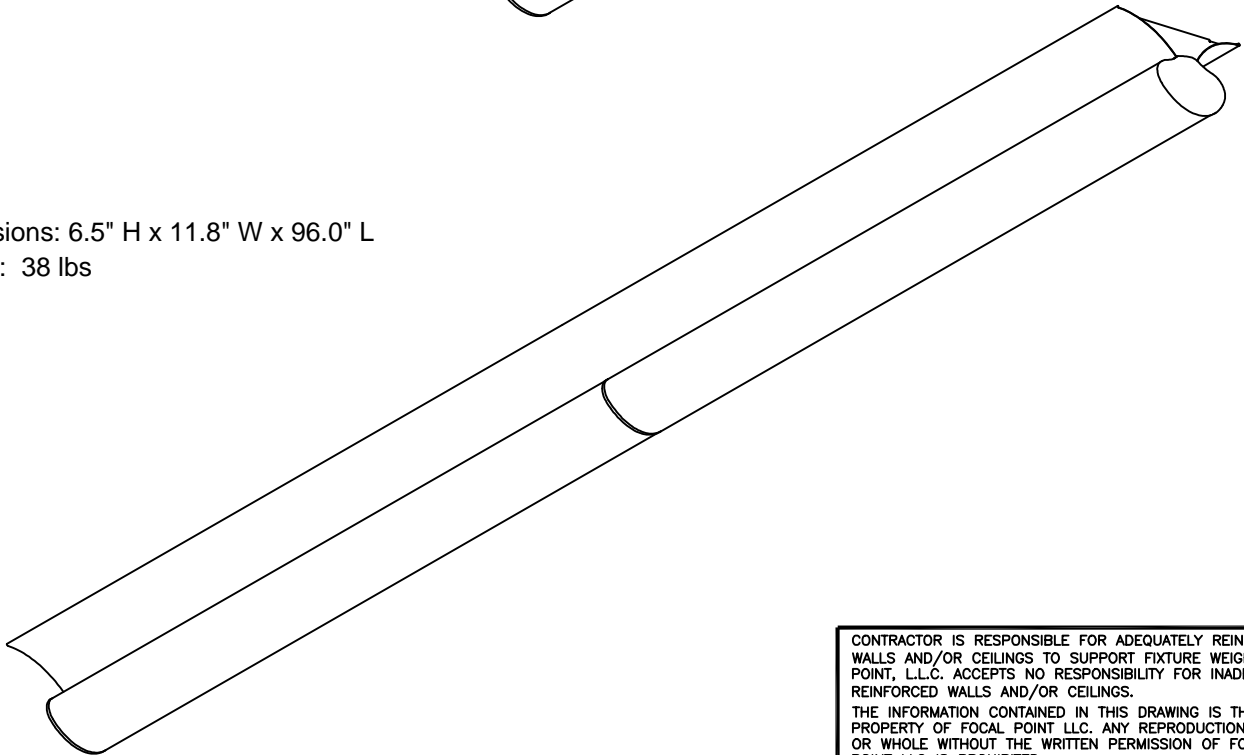

CONTRACTOR IS RESPONSIBLE FOR ADEQUATELY REINFORCING WALLS AND/OR CEILINGS TO SUPPORT FIXTURE WEIGHT. FOCAL POINT, L.L.C. ACCEPTS NO RESPONSIBILITY FOR INADEQUATELY REINFORCED WALLS AND/OR CEILINGS.

THE INFORMATION CONTAINED IN THIS DRAWING IS THE SOLE PROPERTY OF FOCAL POINT LLC. ANY REPRODUCTION IN PART OR WHOLE WITHOUT THE WRITTEN PERMISSION OF FOCAL POINT LLC IS PROHIBITED.

2003 FOCAL POINT LLC



FOCAL POINT

INSTALLATION GUIDE NO.

IS0208

DWG. NO.

REV. A

INDIVIDUAL UNIT INSTALLATION

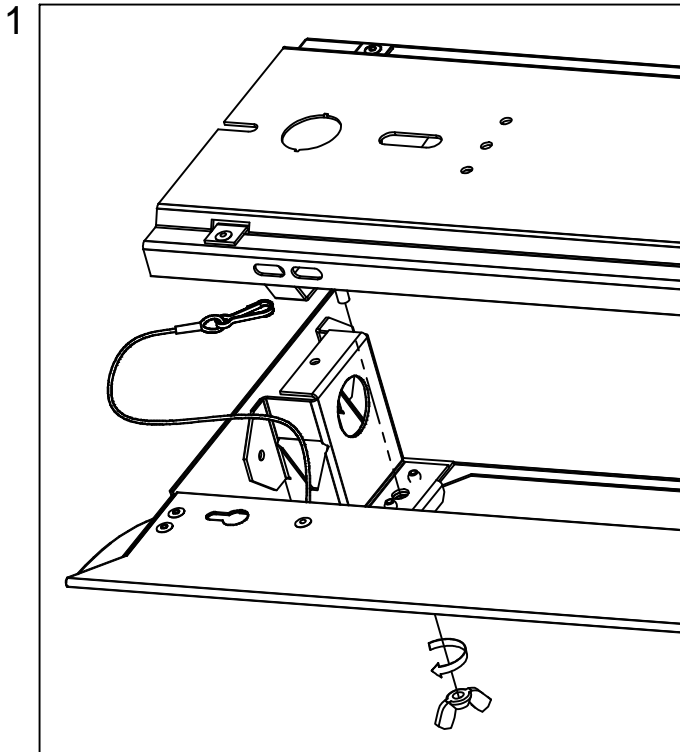
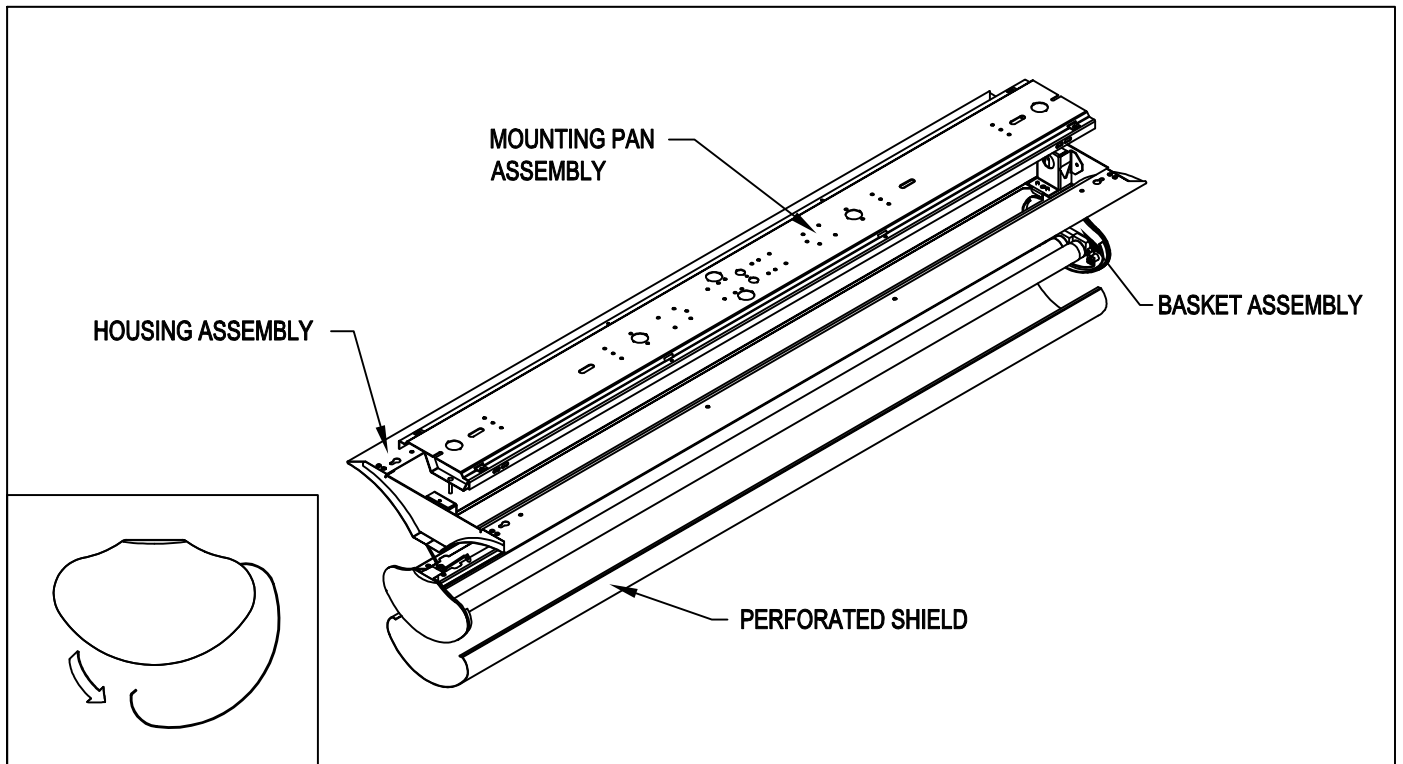

REMOVE MOUNTING PAN ASSEMBLY FROM LUMINAIRE BY LOOSENING (2) #8-32 WING NUTS AND UNCLIP (2) SAFETY HANGING STRAPS.

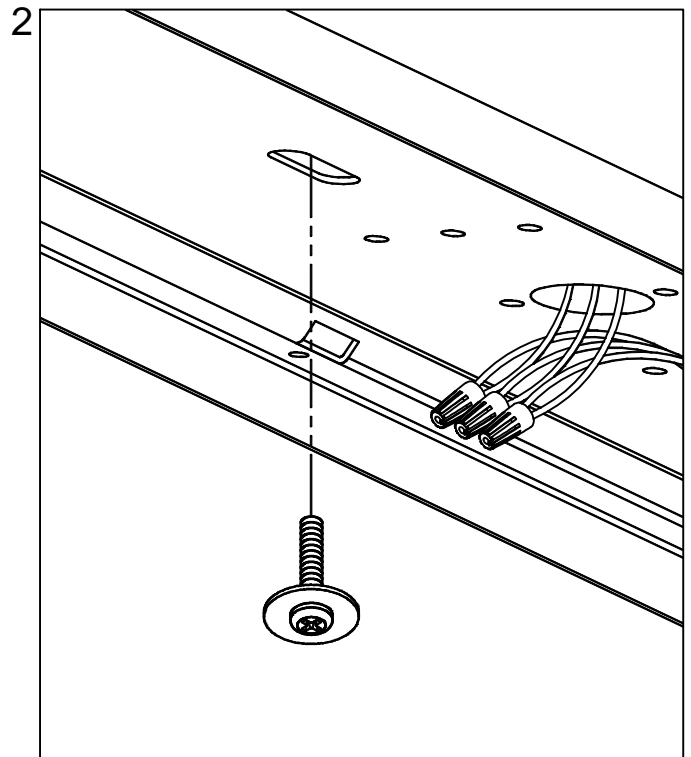

KNOCK OUT DESIRED 7/8" K.O. FOR WIRING. INSTALL MOUNTING PAN TO CEILING AND MAKE POWER CONNECTIONS. (HARDWARE BY OTHERS)

INDIVIDUAL UNIT INSTALLATION (CONTINUED)

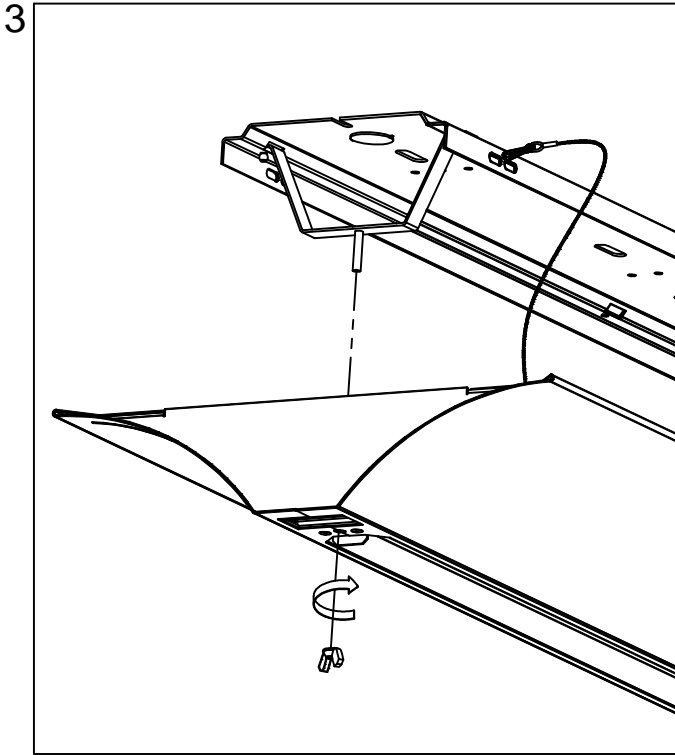

ATTACH HOUSING ASSEMBLY BY RECLIPPING (2) SAFETY STRAPS AND FASTENING (2) WING NUTS.

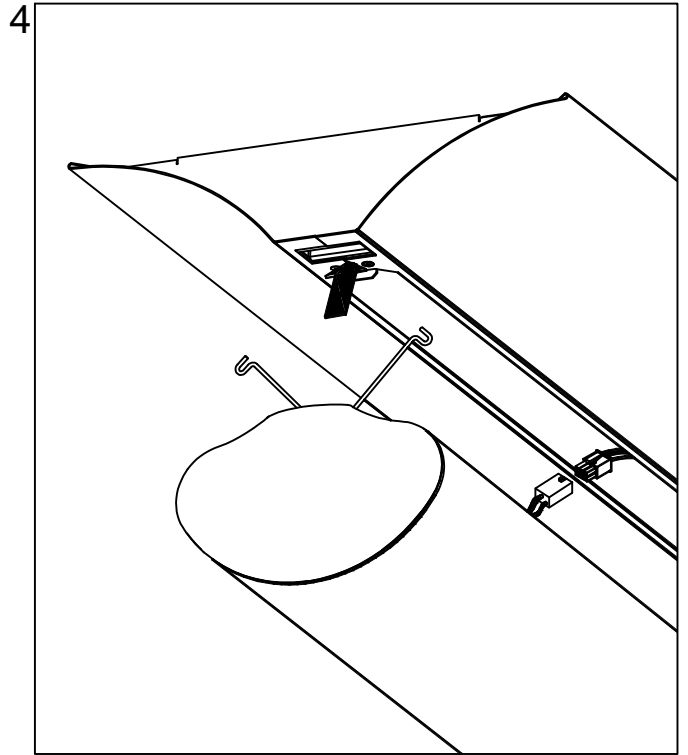

INSERT TORSION SPRINGS INTO RECEIVING HOLES. CONNECT "QUICK DISCONNECT" PLUG AND PUSH BASKET ASSEMBLY UPWARD UNTIL TORSION SPRINGS PULL THE BASKET ASSEMBLY FIRMLY AGAINST HOUSING. INSTALL LAMPS AND REPLACE SHIELD TO COMPLETE INSTALLATION.

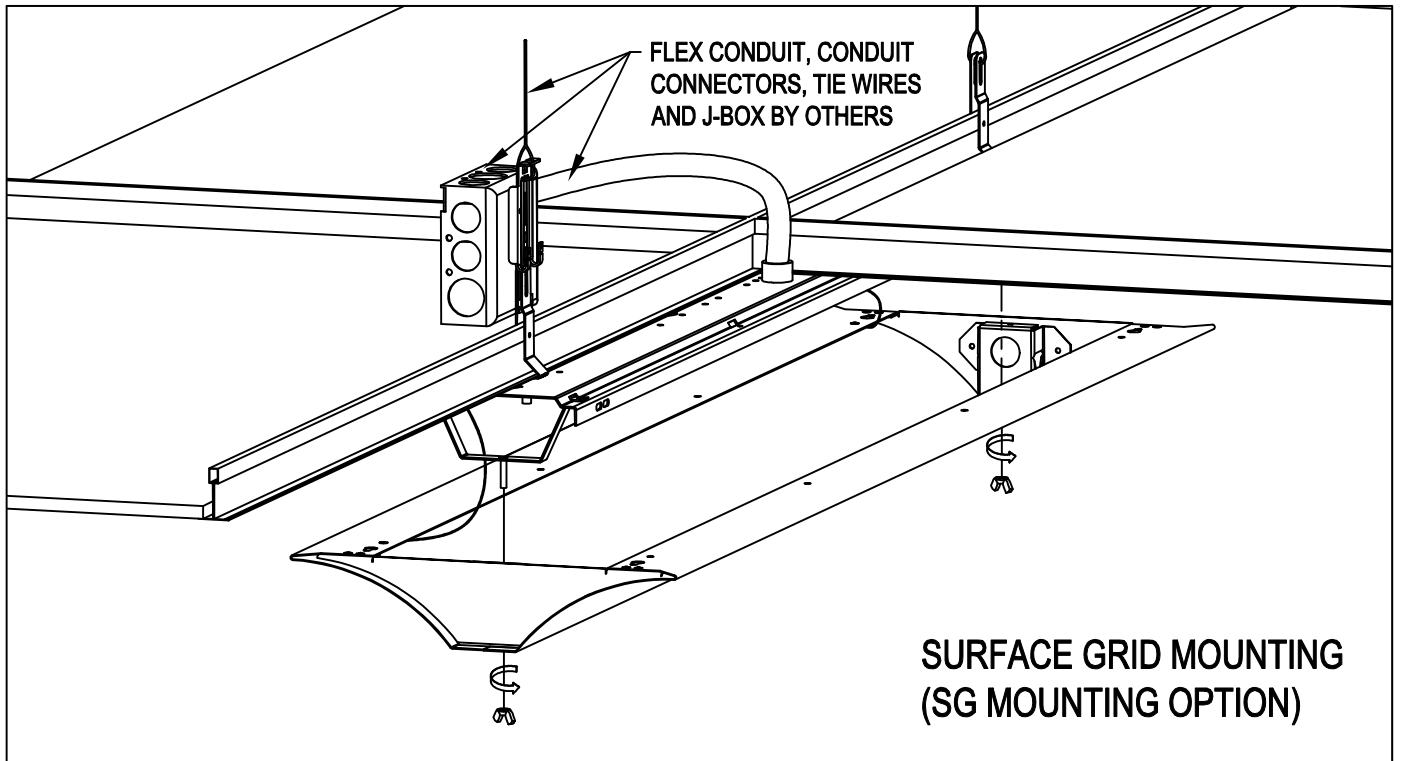

FLEX CONDUIT, CONDUIT CONNECTORS, TIE WIRES AND J-BOX BY OTHERS

**SURFACE GRID MOUNTING
(SG MOUNTING OPTION)**

FOR SURFACE GRID MOUNTING, INSTALL MOUNTING PAN AS SHOWN. MAKE ELECTRICAL CONNECTIONS AND FOLLOW STEPS 3 & 4 FROM ABOVE.

ROW MOUNT INSTALLATION

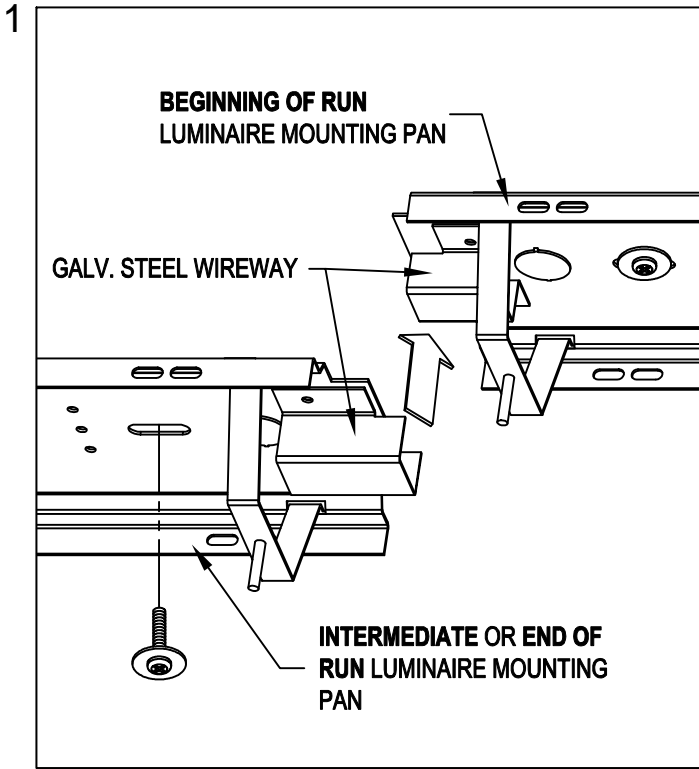

INSTALL MOUNTING PAN OF **BEGINNING OF RUN** LUMINAIRE. ALIGN AND INSTALL MOUNTING PANS OF THE REST OF THE RUN AS SHOWN. (MOUNTING HARDWARE BY OTHERS)

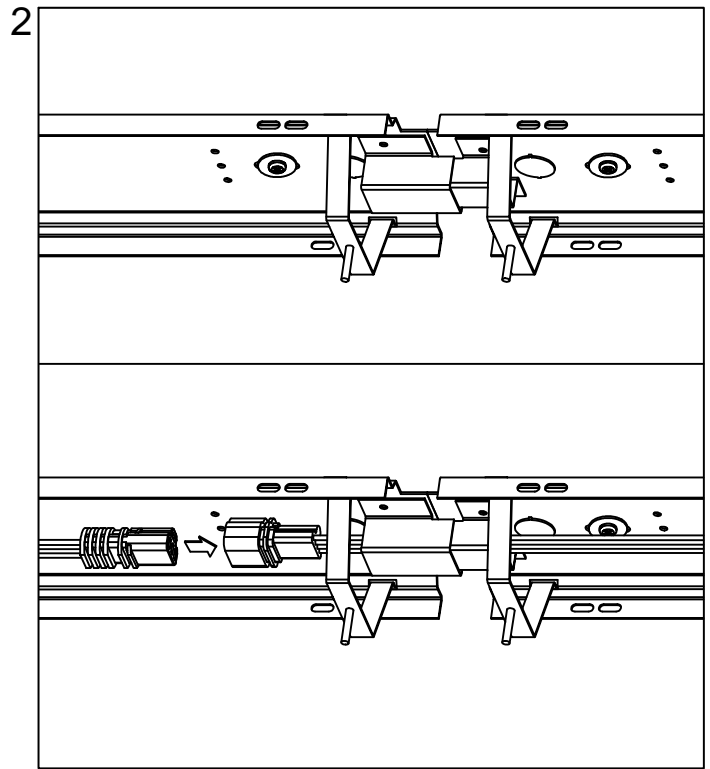

FEED POWER CONNECTOR THROUGH WIREWAY AND CONNECT THE NEXT LUMINAIRE AS SHOWN.

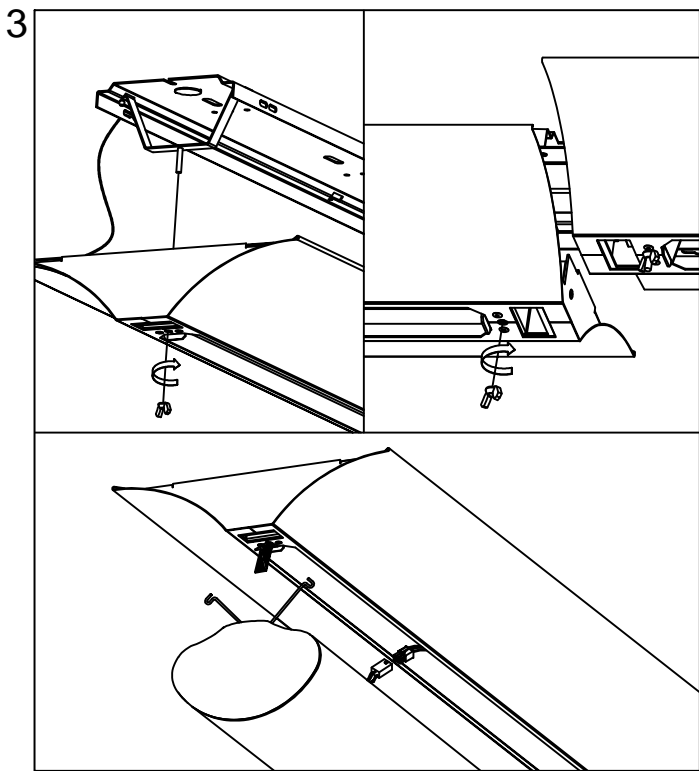

ATTACH HOUSING ASSEMBLY BY RECLIPPING (2) SAFETY STRAPS AND FASTENING (2) WING NUTS. INSERT TORSION SPRINGS INTO RECEIVING HOLES. CONNECT "QUICK DISCONNECT" PLUG AND PUSH BASKET ASSEMBLY UPWARD UNTIL TORSION SPRINGS PULL BASKET ASSEMBLY FIRMLY AGAINST HOUSING.

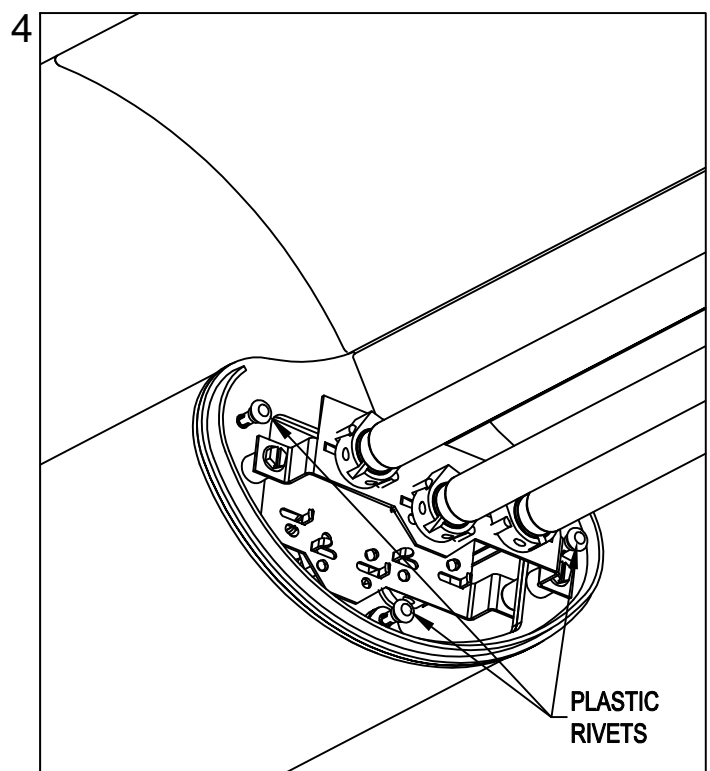

INSERT (3) SUPPLIED PLASTIC RIVETS TO SECURE ALUMINUM END CAPS TOGETHER. INSTALL LAMPS AND REPLACE SHIELD TO COMPLETE INSTALLATION.