

# VERVE II - SUSPENDED - INDIVIDUAL & CONTINUOUS ROW

## SAFETY AND INSTALLATION INSTRUCTIONS

FIXTURES MUST BE INSTALLED BY A QUALIFIED ELECTRICIAN (CHECK WITH LOCAL AND NATIONAL CODES FOR PROPER INSTALLATION). TO PREVENT ELECTRICAL SHOCK, DISCONNECT ELECTRICAL SUPPLY BEFORE INSTALLATION OR SERVICING.

**A: READ ALL INSTRUCTIONS.**

**B: DISCONNECT ELECTRICAL POWER BEFORE SERVICING FIXTURES.**

**C: SAVE THESE INSTRUCTIONS.**

### Parts supplied by Focal Point

#### Hanging Kits

Feed kit

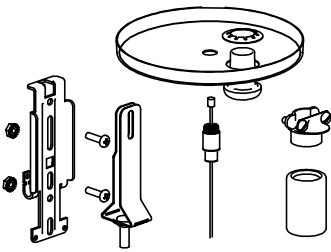

Non-Feed kit

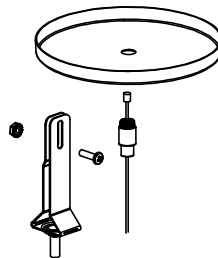

#### Unit Descriptions

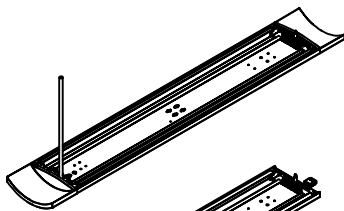

-U  
(IND)  
Individual Unit

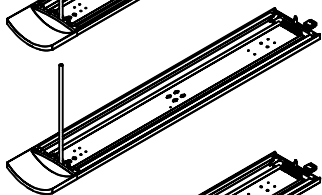

-S  
(BOR)  
Beginning Of Run Unit

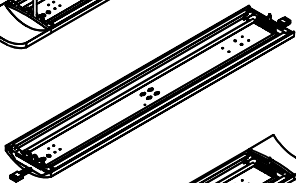

-I  
(INT)  
Intermediate Unit

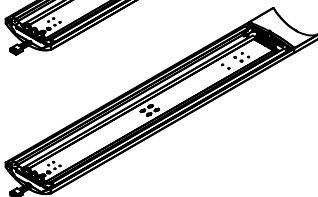

-E  
(EOR)  
End Of Run Unit

CONTRACTOR IS RESPONSIBLE FOR ADEQUATELY REINFORCING WALLS AND/OR CEILINGS TO SUPPORT FIXTURE WEIGHT. FOCAL POINT, L.L.C. ACCEPTS NO RESPONSIBILITY FOR INADEQUATELY REINFORCED WALLS AND/OR CEILINGS.

THE INFORMATION CONTAINED IN THIS DRAWING IS THE SOLE PROPERTY OF FOCAL POINT LLC. ANY REPRODUCTION IN PART OR WHOLE WITHOUT THE WRITTEN PERMISSION OF FOCAL POINT LLC IS PROHIBITED.

2001 © FOCAL POINT LLC



FOCAL POINT®

INSTALLATION GUIDE NO.

ISO187

DWG. NO.

REV. B

# INSTALLATION GUIDE

USE WHEN SUSPENDING INDIVIDUAL UNITS OR CONTINUOUS ROW MOUNTED UNITS.

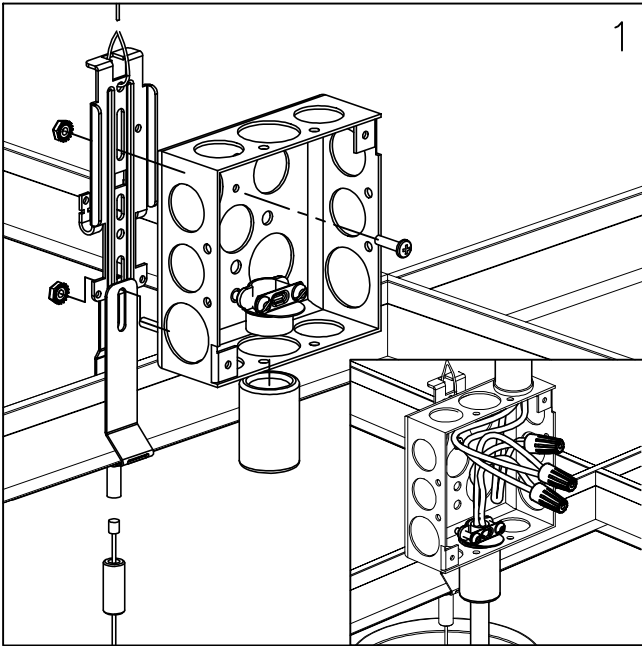

FOLLOW INSTRUCTIONS FOR UNIVERSAL SUSPENSION SYSTEM **IS0166** FOR EACH FEED/SUSPENSION LOCATION (INSTALLATION HARDWARE AND INSTRUCTIONS SHIPPED IN RED BOX SEPARATE FROM FIXTURES).

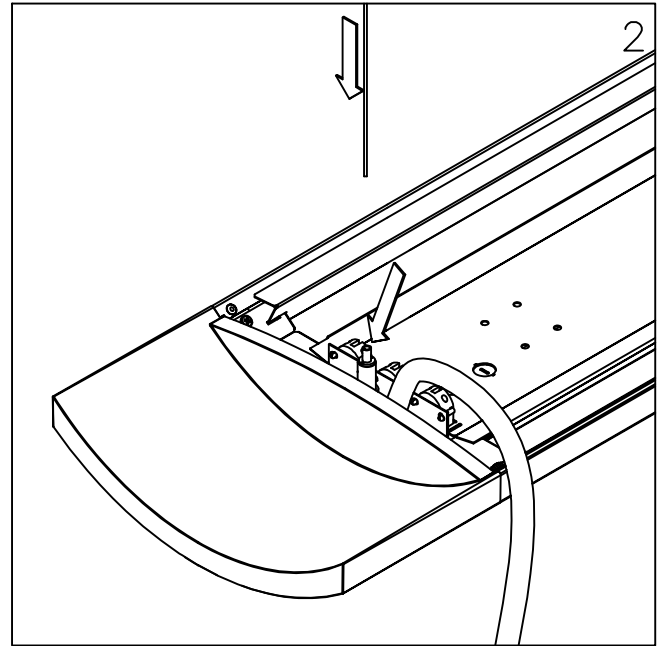

BEGIN WITH FEED END OF **IND** OR **BOR** FIXTURE. DEPRESS PLUNGER ON CABLE ADJUSTER AND THREAD AIRCRAFT CABLE INTO HOLE. GRASP END OF CABLE WITH PLIERS AS IT EXITS THE ADJUSTER. GUIDE CABLE TOWARD OUTER EDGE OF FIXTURE ALONG BULKHEAD. RELEASE PLUNGER TO GRIP CABLE AT DESIRED SUSPENSION HEIGHT. CUT EXCESS IF NECESSARY.

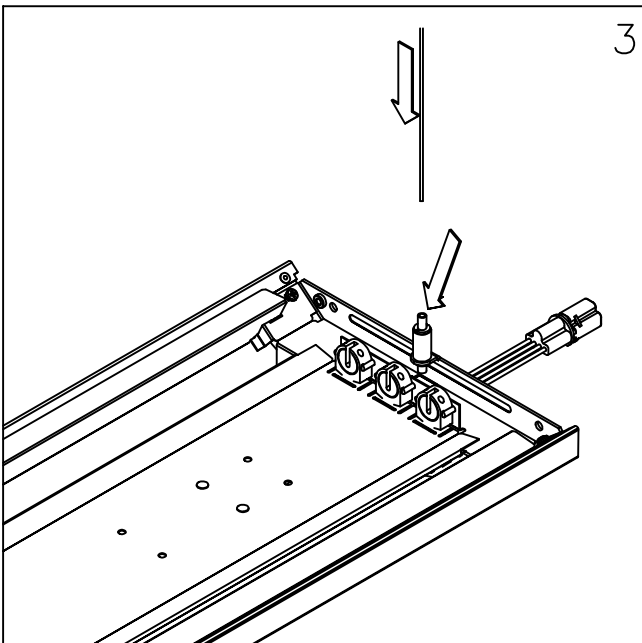

SUSPEND OPPOSITE END OF **IND** OR **BOR** FIXTURE THE SAME WAY. FOR **SINGLE UNIT INSTALLATION**, LEVEL FIXTURE NOW. ONCE UNIT IS LEVEL, AND LAMPS ARE INSTALLED, SINGLE UNIT INSTALLATION IS COMPLETE.

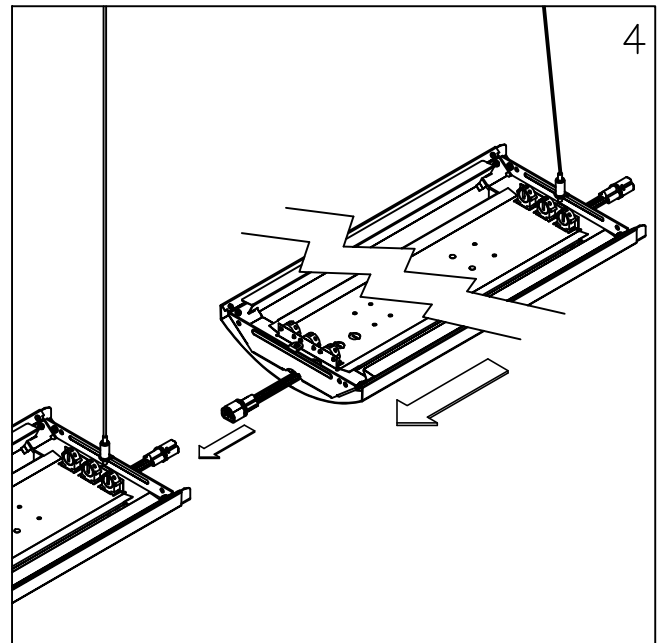

FOR **CONTINUOUS ROW MOUNTING**, SUSPEND FAR END OF **INT** OR **EOR** UNIT TO BE JOINED. SWING LOOSE END OF FIXTURE UP AND CONNECT WIRE HARNESS OF **INT** OR **EOR** FIXTURE WITH **BOR** FIXTURE. PUSH EXCESS WIRE BACK INTO FIXTURE.

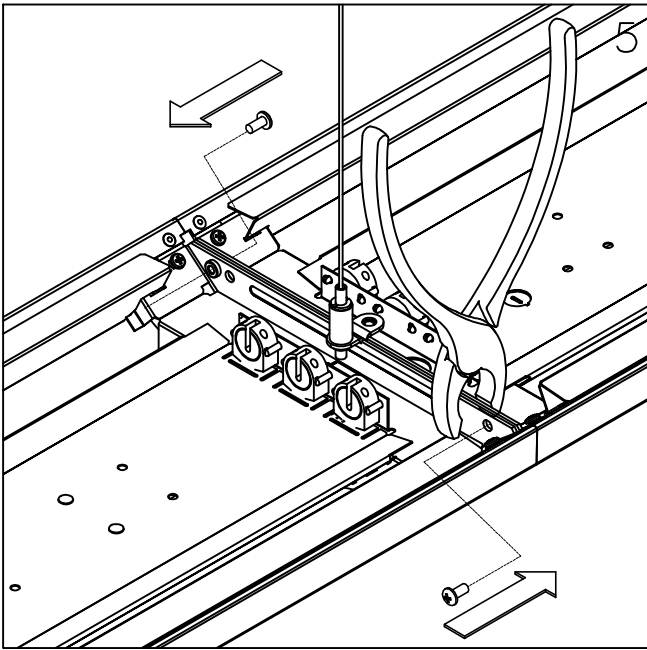

ALIGN AND CONNECT BULKHEADS OF UNITS TO BE JOINED. USE PLIERS TO SQUEEZE UNITS TIGHTLY TOGETHER. TIGHTEN (2) PRE-INSERTED SCREWS IN EACH BULKHEAD TO SECURE UNITS TOGETHER.

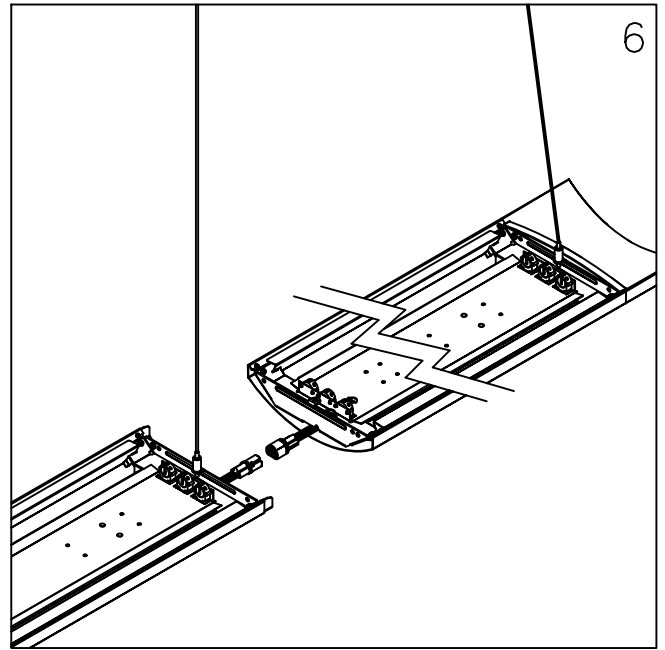

CONTINUE CONNECTING WIRE HARNESES AND JOINING BULKHEADS AT EACH SUSPENSION POINT UNTIL THE END OF THE RUN. ALWAYS SUSPEND FAR END OF FIXTURE BEING ADDED TO RUN PRIOR TO CONNECTING WIRE HARNESES.

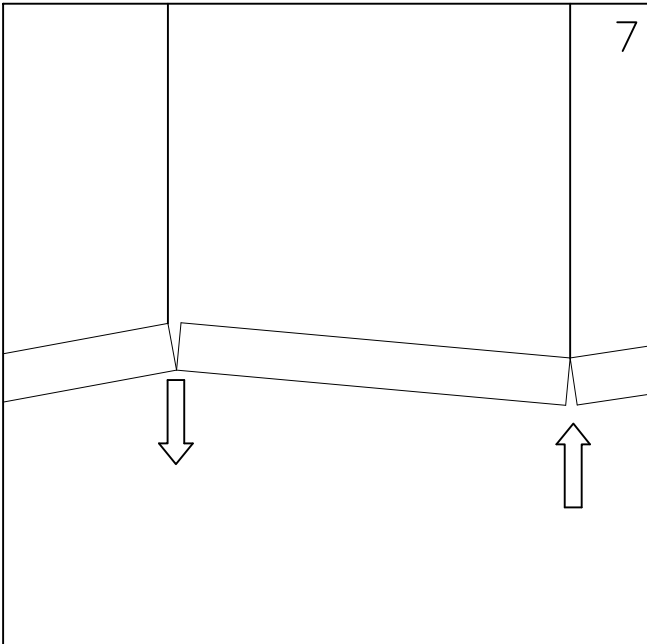

WHEN ALL **BOR**, **INT** AND **EOR** UNITS ARE CONNECTED AND SUSPENDED AT DESIRED HEIGHT, LEVEL ENTIRE RUN BY ADJUSTING INDIVIDUAL SUSPENSION POINTS.

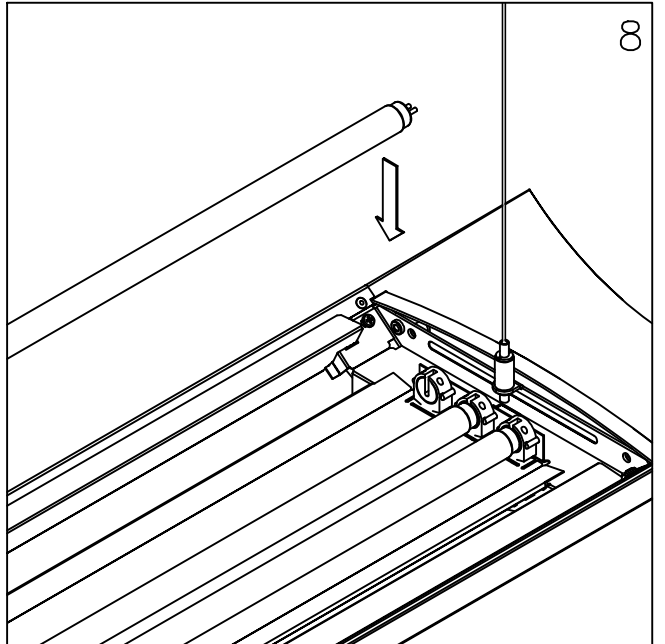

INSTALL LAMPS AND POWER RUN.