

surface mount  
**skydome™**

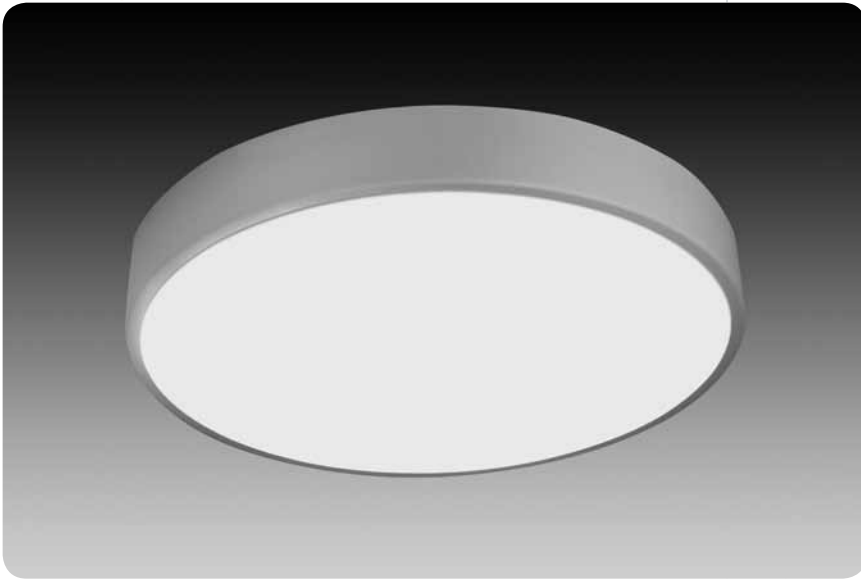

**features**

2', 3' and 4' diameter surface mount direct fluorescent with frosted acrylic lens.

Frosted acrylic lens is textured on one side to provide smooth distribution and eliminate lamp image.

Multiple lamp options provide a variety of light output.

Convex lens design and precision lamp placement ensures an evenly illuminated diffuser.

Skydome™ is an excellent choice for open public spaces such as airport concourses, large lobbies, reception areas and meeting rooms.

**dimensional data**

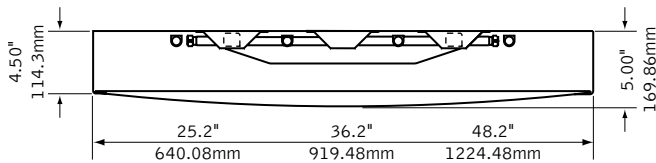

**lampping options**

**2' diameter**

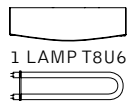
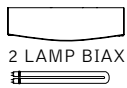

**3' diameter**

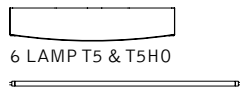

**4' diameter**

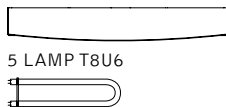

**companion luminaire**



pendant



recessed

**performance**

3' Diameter  
6-Lamp T5H0  
59% Efficiency  
3877 cd @ 0°

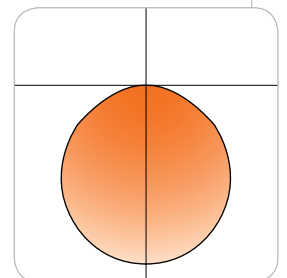

Visit [focalpointlights.com](http://focalpointlights.com) for complete photometric data.

fixture:

project:

## details

### lamping options

2' diameter

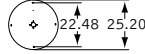
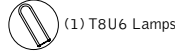

3' diameter

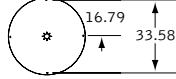
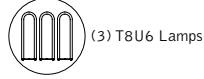
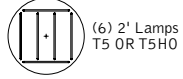

4' diameter

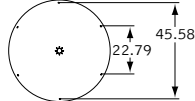
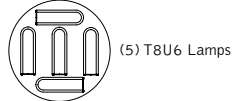
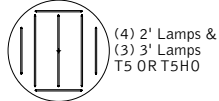

### mounting

## specifications

### construction

One-piece 16 Ga. spun steel housing.

One-piece 18 Ga. spun steel mounting plate.

Housing and lens is secured to mounting plate by torsion springs.

Bottom access to ballast compartment.

2' unit weight: 37 lbs.

3' unit weight: 53 lbs.

4' unit weight: 78 lbs.

### optic

One-piece 20 Ga. steel reflector finished in High Reflectance White powder coat.

Convex lens of .125" thick white acrylic is secured to housing and removed with torsion springs.

### electrical

Electronic ballasts are thermally protected and have a Class "P" rating.

Optional dimming ballasts available.

Consult factory for dimming specifications and availability.

UL and cUL listed.

### finish

Polyester powder coat applied over a 5-stage pre-treatment.

## ordering

luminaire series Skydome FSD

nominal size \_\_\_\_\_

2' Diameter 22

3' Diameter 33

4' Diameter 44

distribution D

Direct Symmetrical D

lamp quantity \_\_\_\_\_

2' Diameter

Two Lamp 55W Biax 2BX55

One Lamp T8U6 1T8U6

3' Diameter

Three Lamp T8U6 3T8U6

Six Lamp T5 6T5

Six Lamp T5H0 6T5H0

4' Diameter

Five Lamp T8U6 5T8U6

(3) 21W T5 & (4) 14W T5 7T5

(3) 39W T5H0 & (4) 24W T5H0 7T5H0

ballast \_\_\_\_\_

Electronic Instant Start <20% THD E

(Not available for T5/T5H0)

Electronic Program Start <10% THD S

Electronic Dimming Ballast\* D

voltage \_\_\_\_\_

120 Volt 120

277 Volt 277

347 Volt 347

mounting SM

Surface Mount SM

shielding CX

Convex Lens CX

factory options \_\_\_\_\_

Emergency Battery Pack\* EM

HLR/GLR Fuse FU

Flex Whip\* FW

Include 3000K Lamp\* L830

Include 3500K Lamp\* L835

Include 4100K Lamp\* L841

Separate Circuit\* SC

(may cause loss of uniformity)

Lutron™ Sensor Feed\* SF

(EcoSystem ballast & controls required)

finish \_\_\_\_\_

Matte Satin White WH

Titanium Silver TS

\* for more information see Reference section.

# surface mount skydome™



Filename: FSD336T5H.IES  
 Catalog #: FSD-33-D-6T5H0-E-120-SM-CX-WH  
 Efficiency: 59%  
 Test #: 12353.0

## CANDLEPOWER DISTRIBUTION

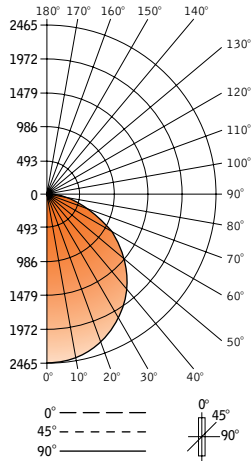

Spacing 1.3  
 Criterion: 1.3

Vertical Angle	Horizontal Angle				Zonal Lumens
	0°	22.5°	45°	67.5°	
0°	2462	2462	2462	2462	2462
5°	2461	2451	2451	2449	2451
15°	2379	2370	2369	2368	2369
25°	2211	2198	2210	2206	2212
35°	1969	1956	1961	1963	1967
45°	1655	1642	1655	1648	1661
55°	1277	1278	1282	1281	1281
65°	894	873	882	880	900
75°	479	469	483	472	468
85°	146	139	140	134	146
90°	48	49	43	45	45
95°	6	5	3	6	7
105°	0	0	0	0	0
115°	0	0	0	0	0
125°	0	0	0	0	0
135°	0	0	0	0	0
145°	0	0	0	0	0
155°	0	0	0	0	0
165°	0	0	0	0	0
175°	0	0	0	0	0
180°	0	0	0	0	0

## LUMEN SUMMARY

Zone	Lumens	% Lamp	% Fixt
0°-30°	1927	16.1	27.1
0°-40°	3160	26.3	44.4
0°-60°	5586	46.6	78.4
0°-90°	7117	59.3	99.9
<b>Total Luminaire</b>	<b>0°-180°</b>		

## LUMINANCE DATA (CD/M<sup>2</sup>)

Vertical Angle	0°	45°	90°
45°	4130	3889	3903
55°			
65°	3929	3623	3620
75°	3733	3250	3316
85°	3266	2674	2591

## CO-EFFICIENTS OF UTILIZATION

Floor	80				70				50				30				10				00			
	70	50	30	10	70	50	30	10	50	10	50	10	50	10	50	10	50	10	50	10	50	10	50	10
Wall	71	71	71	71	69	69	69	69	66	66	66	66	63	63	63	63	61	61	61	61	59	59	59	59
RCR 0	71	71	71	71	69	69	69	69	66	66	66	66	63	63	63	63	61	61	61	61	59	59	59	59
1	65	62	60	58	63	61	57	58	55	56	53	54	52	50	54	52	50	48	44	43	43	36	36	36
2	59	55	51	48	58	54	47	52	46	50	45	48	44	43	44	38	38	38	38	31	31	27	27	27
3	54	48	44	40	53	48	40	46	39	44	38	43	38	36	39	33	33	33	33	27	27	23	23	23
4	50	43	38	34	49	42	34	41	33	39	33	38	33	31	35	28	28	28	28	23	23	19	19	19
5	46	38	33	29	44	37	29	36	28	35	28	34	28	27	31	24	24	24	24	20	20	17	17	17
6	42	34	29	25	41	33	25	32	25	31	24	30	24	23	28	21	21	21	21	19	19	15	15	15
7	39	31	25	22	38	30	22	29	21	28	21	27	21	20	25	18	18	18	18	17	17	13	13	13
8	35	27	22	19	35	27	19	26	19	25	18	24	18	17	22	16	16	16	16	15	15	11	11	11
9	33	24	20	16	32	24	16	23	16	23	16	22	16	15	21	14	14	14	14	13	13	9	9	9
10	30	22	17	14	29	22	14	21	14	21	14	20	14	13	19	13	13	13	13	11	11	7	7	7

Numbers indicate percentage values of