

0-35° gimbal accent

id®



HAL



features

Lamp is positioned just above ceiling level for added efficiency and visual interest.

Tilt and rotate by hand for quick and easy adjustment.

Trims available in Overlap flange or Flush mud-in for a seamless appearance.

Perfect Fit™ installation process provides seamless integration in plaster, drywall and acoustical tiles.

Standard white finish is field paintable.

trim assembly

trim with gimbal

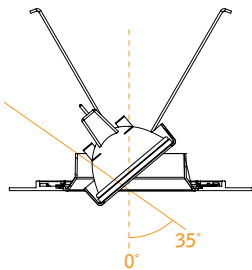

flush trim  
(drywall only)

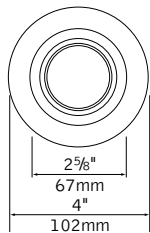

overlap trim

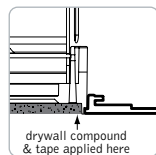
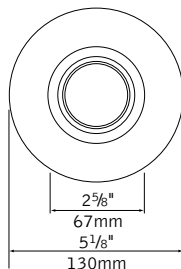

ceiling cutout dimensions:  
6 3/16"

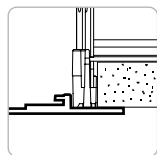

ceiling cutout dimensions:  
T Housings - 4 11/16"  
RT Housing - 4 5/8"

housing types

T

14" x 7.625" x 5" h

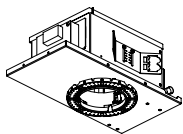

IC (air-tight)

16.5" x 10" x 9" h

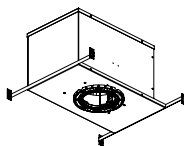

RT

11.64" x 6.59" x 5.58" h

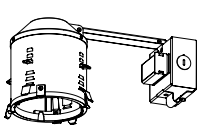

overlap faceplate only

fixture:

project:

## housing specifications

### lamp

Halogen MR16 lamp provides numerous beam options from 10° to 40° (60° not recommended).

### construction

(T)Thermally protected housing for new construction applications without direct contact with insulation. Insulation to be kept 3" away from housing. Unit is enclosed in 20ga. Black painted CRS housing, which eliminates stray light into the plenum, on a 20ga. CRS frame. Housing ships standard with butterfly brackets which mount to ½ emt or channel and vertically adjust 2". Bar hangers are an option and must be specified when ordering T-rated housing. Transformer is accessible from below ceiling. Unit may be relamped from above. Fixture will not exceed 7.5lbs.

(IC) Insulated ceiling housing for new construction applications with direct insulation contact. Unit is constructed of double wall 18ga. aluminum housing on a 20ga. CRS frame. Housing ships standard with locking bar hangers. Transformers and thermal protectors are accessible from below ceiling. Housing is gasketed and complies with ASTM E-283, air-tight energy codes. Fixture will not exceed 11lbs.

(RT)Remodel, thermally protected housing for remodel construction applications without direct contact with insulation. Insulation to be kept 3" away from housing. Unit is 20ga. black painted CRS with contoured top and hinging J-box arm. Housing locks into finished ceiling via 4 removable spring clips. J-box and transformers are accessible by removing housing from ceiling. Fixture will not exceed 4.5lbs.

### electrical

Porcelain bi-pin socket with #18 Teflon leads with keyed quick connection. Acoustically isolated transformer, replaceable from below, mounted outside of housing to ensure cool operation and minimize hum. Transformers available in either electronic or magnetic 120V or 277V. For residential dimming applications, toroidal magnetic transformer is available. Large junction box with pryouts. UL listed for thru branch wiring, four #12 90°C conductors for T housing and two #14 90°C conductors for RT and IC housing.

### installation

Adjustable throat allows infinite adjustment for ½" to 1½" thick ceilings. Shipped in ½" ceiling position. For thicker ceilings consult factory.

Ceiling thickness adjustment sleeve locks with supplied ⅝" hex driver.

Sleeve allows fine tuning of the housing for a perfect fit. Comes with laser/string alignment guides.

Housing ships with dust cover.

## trim specifications

### aesthetics

Two piece MR16 assembly includes spun lamp tray and beveled ring.

Matte white finish may be used as a primer coat for field painting. Smart Lock™ ring allows disassembly for custom field painting of faceplate.

### adjustment

Lens tray can hold up to two accessories, up to ⅝" thick. Simple tilt by hand adjustment up to 35°.

### optics

Lamp rests slightly above ceiling level.

### construction

Trim stays captive to housing during relamping via torsion springs.

Torsion springs pull trim tight to the ceiling.

No visible fasteners within the trim.

Mechanical light traps eliminate light leaks.

Warp free die-cast aluminum faceplate, .040" thick flange on overlap versions.

### labels

UL listed, Damp label standard.

No visible labels when trim is installed.

## housing ordering

housing series FD4

Halogen Housing FD4

lamp MR

MR16 Lamp MR

transformer type \_\_\_\_\_

Electronic Dimming 120V, 11.7V E1

Electronic Dimming 277V, 11.7V E2

Magnetic Dimming 120V, 11.7V M1  
(T housing only)

Magnetic Dimming 277V, 11.7V M2  
(T housing only)

Toroidal Dimming 120V M1T  
(IC & RT housings only)

faceplate type \_\_\_\_\_

Round Flush RF  
(T & IC housings only)

Round Overlap RO

housing type \_\_\_\_\_

(50W max)

New Construction T Rated, up to 1½" ceilings T

New Construction T Rated, 1½" to 2½" ceilings T2

New Construction T Rated, 2½" to 3½" ceilings T3

New Construction IC Rated, up to 1½" ceilings IC

New Construction IC Rated, 1½" to 2½" ceilings IC2

New Construction IC Rated, 2½" to 3½" ceilings IC3

Remodel T Rated (overlap faceplate only) RT

factory options \_\_\_\_\_

Bar Hangers BH  
(T housing only)

Wattage Restriction Label (XX=wattage) WRXX

Chicago Plenum CP  
(T housing only)

## trim ordering

trim aperture D2

2½" Aperture D2

faceplate type \_\_\_\_\_

Round Flush RF  
(T & IC housing only) (drywall only)

Round Overlap RO

optic AAG

Adjustable Gimbal Accent AAG

faceplate finish \_\_\_\_\_

White WH

Black BK

Titanium Silver TS

lens accessories \_\_\_\_\_

(soft focus lens supplied as standard)

Hex Louver HL

Linear Spread Lens LSL

Prismatic Spread Lens PSL

Sand Blasted Lens SBL

Clear Lens CL

UV Lens UVL

a complete unit consists of two line items, housing and trim

example: FD4-MR-E1-RF-T

D2-RF-AAG-WH