

0-45° accent – pinhole
id®

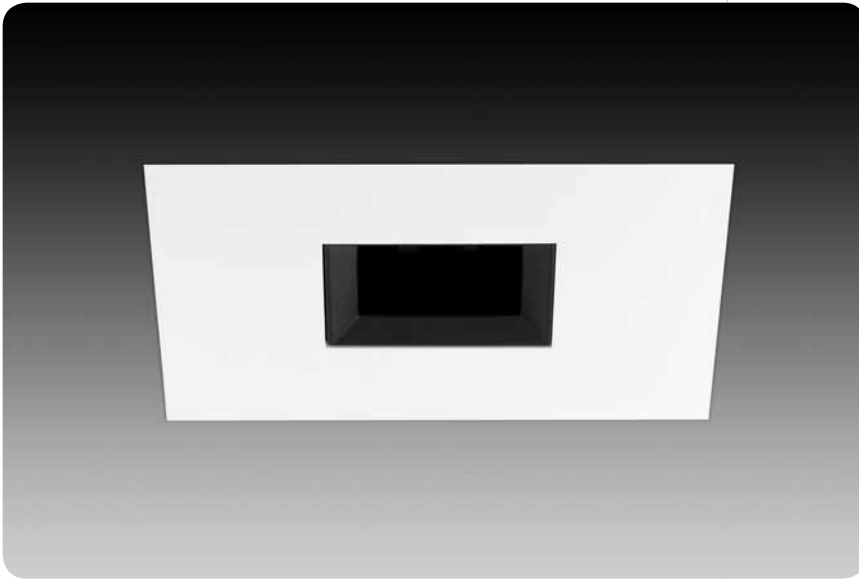

Covered by US Patent: 7,748,868

features

Trims available in Overlap flange or Flush mud-in for a seamless appearance.

Gloves Off™ hot aiming made simple with gear drive for both 45° vertical and 363° horizontal adjustment; Self locking.

Auto Memory remembers original lamp position after relamping. Lenses are independent of lamp, and remain undisturbed during relamping.

Perfect Fit™ installation process provides seamless integration in plaster, drywall and acoustical tiles, while maintaining optics in any ceiling thickness.

Adjustment mechanism provides for:

- easy relamping
- locking of both vertical and horizontal aiming
- lowers for easy lamp and lens access.

Smart Lock™ ring allows quick removal and re-assembly of trim components for field painting.

Standard white finish is field paintable.

Interchangeable lamp and trim mechanisms allow for maximum flexibility, even after luminaire is installed.

trim option



trim without black bevel

lens accessories

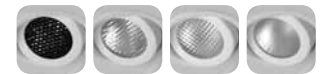

hex louver linear prismatic sand blasted

trim assembly

trim with adjustment mechanism

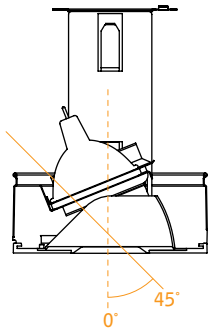

flush trim (drywall only)

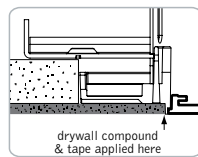
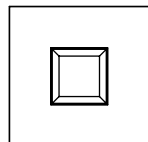

ceiling cutout dimensions: 6 3/16"

overlap trim

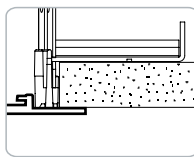
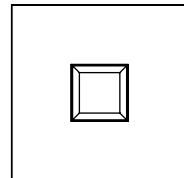

ceiling cutout dimensions: T & IC Housings - 4 11/16" RT Housing - 4 5/8"

housing types

T

14" x 7.625" x 5" h

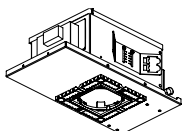

IC (air-tight)

16.5" x 10" x 9" h

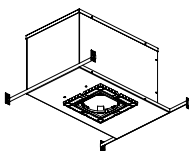

RT

12.08" x 6.32" x 5.58" h

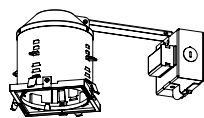

overlap faceplate only

performance

Accent Pinhole
Q71MR16/C/NSP15
3285 cd @ 30° (30° tilt)

For optimal performance, rotate lamp on axis to 0°, 90°, 180° or 270°.

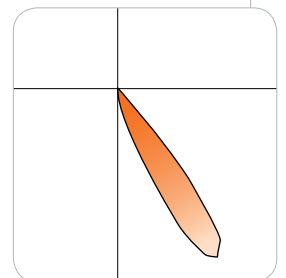

Visit focalpointlights.com for complete photometric data.

fixture:

project:

housing specifications

lamp

Halogen MR16 lamp provides numerous beam options from 10° to 40° (60° not recommended).

construction

(T)Thermally protected housing for new construction applications without direct contact with insulation. Insulation to be kept 3" away from housing. Unit is enclosed in 20ga. black painted CRS housing, which eliminates stray light into the plenum, on a 20ga. CRS frame. Housing ships standard with butterfly brackets which mount to ½ emt or channel and vertically adjust 2". Bar hangers are an option and must be specified when ordering T-rated housing. Transformer is accessible from below ceiling. Unit may be relamped from above. Fixture will not exceed 7.5lbs.

(IC) Insulated ceiling housing for new construction applications with direct insulation contact. Unit is constructed of double wall 18ga. aluminum housing on a 20ga. CRS frame. Housing ships standard with locking bar hangers. Transformers and thermal protectors are accessible from below ceiling. Housing is gasketed and complies with ASTM E-283, air-tight energy codes. Fixture will not exceed 11lbs.

(RT)Remodel, thermally protected housing for remodel construction applications without direct contact with insulation. Insulation to be kept 3" away from housing. Unit is 20ga. black painted CRS with contoured top and hinging J-box arm. Housing locks into finished ceiling via 4 removable spring clips. J-box and transformers are accessible by removing housing from ceiling. Fixture will not exceed 4.5lbs.

electrical

Porcelain bi-pin socket with #18 Teflon leads with keyed quick connection. Acoustically isolated transformer, replaceable from below, mounted outside of housing to ensure cool operation and minimize hum. Transformers available in either electronic or magnetic 120V or 277V. For residential dimming applications, toroidal magnetic transformer is available. Large junction box with pryouts. UL listed for thru branch wiring, four #12 90°C conductors for T housing and two #14 90°C conductors for RT and IC housing.

installation

Adjustable throat allows infinite adjustment for ½" to 1½" thick ceilings. Shipped in ½" ceiling position. For thicker ceilings consult factory.

Ceiling thickness adjustment sleeve locks with supplied ⅜" hex driver. Sleeve allows fine tuning of the housing for a perfect fit. Square housing allows 45° rotation to square up the edges of the trim with the architecture and adjacent trims. Comes with laser/string alignment guides.

Housing ships with dust cover.

trim specifications

aesthetics

Diminutive black knife edge baffle minimizes brightness. Truncated Specular black reflector cone above ensures glare free optics. Reflector is .040" spun aluminum. Matte white finish may be used as a primer coat for field painting. Smart Lock™ ring allows disassembly for custom field painting.

adjustment mechanism

Auto Memory for relamping, lamp returns to preset aiming position. Mechanism is matte black finish, and holds lamp and lenses independently. Hot aiming with Philips screwdriver allows 45° vertical tilt, and 363° rotation and locks into position. Mechanism pulls down for quick and easy relamping. Vertical angle and horizontal rotation indicators display positioning. For optimal performance, rotate lamp on axis to 0°, 90°, 180° or 270°.

Tempered soft focus lens supplied as standard.

Lens tray can hold up to three accessories, up to ⅜" thick. Lenses remain undisturbed during relamping.

optics

50° cutoff to the lamp and lamp image.

construction

Trim stays captive to housing during relamping via torsion springs.

Torsion springs pull trim tight to the ceiling and install in 90° increments.

No visible fasteners within the trim.

Mechanical light traps eliminate light leaks.

Warp free die-cast aluminum faceplate, .040" thick flange on overlap versions.

labels

UL listed, Damp label standard.

No visible labels when trim is installed.

housing ordering

housing series		FD4
Halogen Housing	FD4	
lamp		MR
MR16 Lamp	MR	
transformer type		
Electronic Dimming 120V, 11.7V	E1	
Electronic Dimming 277V, 11.7V	E2	
Magnetic Dimming 120V, 11.7V (T housings only)	M1	
Magnetic Dimming 277V, 11.7V (T housings only)	M2	
Toroidal Dimming 120V (IC & RT housings only)	M1T	
faceplate type		
Square Flush (T & IC housings only)	SF	
Square Overlap	SO	
housing type (T Rated: 71W max. IC Rated & Remodel: 50W max.)		
New Construction T Rated, up to 1½" ceilings	T	
New Construction T Rated, 1½" to 2½" ceilings	T2	
New Construction T Rated, 2½" to 3½" ceilings	T3	
New Construction IC Rated, up to 1½" ceilings	IC	
New Construction IC Rated, 1½" to 2½" ceilings	IC2	
New Construction IC Rated, 2½" to 3½" ceilings	IC3	
Remodel T Rated (overlap faceplate only)	RT	
factory options		
Bar Hangers (T housings only)	BH	
Wattage Restriction Label (XX=wattage)	WRXX	
Chicago Plenum (T housings only)	CP	
trim ordering		
trim aperture		D1
1½" Aperture	D1	
faceplate type		
Square Flush (T & IC housing only) (drywall only)	SF	
Square Overlap	SO	
optic		
Pinhole with Black Bevel	PIN	
Pinhole without Black Bevel	PINX	
faceplate finish		
White	WH	
Black	BK	
Titanium Silver	TS	
Aluminum Raw	AL	
lens accessories (soft focus lens supplied as standard)		
Hex Louver	HL	
Linear Spread Lens	LSL	
Prismatic Spread Lens	PSL	
Sand Blasted Lens	SBL	
Clear Lens	CL	
UV Lens	UVL	

a complete unit consists of two line items, housing and trim
example: FD4-MR-E1-SF-T / D1-SF-PIN-HH

sqr accent – pinhole
id®

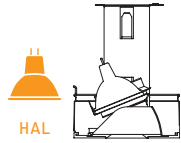

Luminaire: 71W MR16 pinhole accent downlight, narrow spot distribution with soft focus lens
 Filename: D1SXPINHA71NS15_0.ies and D1SXPINHA71NS15_30.ies
 Catalog #: D1-SX-PIN-WH
 Efficiency: 54% (0° tilt), 35% (30° tilt)
 Photometric Report #: 13561.0 and 13562.0

CANDLEPOWER DISTRIBUTION - 0° TILT

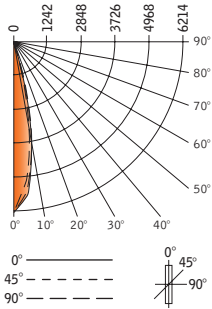

Vertical Angle	Horizontal Angle				
	0°	22.5°	45°	67.5°	90°
0°	4539	4539	4539	4539	4539
5°	3854	4035	4037	3932	4113
15°	644	722	909	924	838
25°	82	85	116	97	55
35°	11	12	13	10	7
45°	2	5	5	4	0
55°	0	0	0	0	0
65°	0	0	0	0	0
75°	0	0	0	0	0
85°	0	0	0	0	0
90°	0	0	0	0	0

CANDLEPOWER DISTRIBUTION - 30° TILT

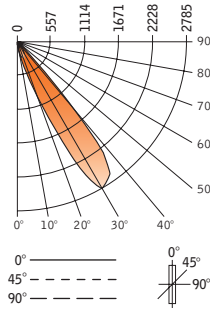

Vertical Angle	Horizontal Angle				
	0°	22.5°	45°	67.5°	90°
0°	24	24	24	24	24
5°	75	65	48	34	25
15°	651	559	230	63	16
25°	2711	1489	299	39	7
35°	2785	822	99	10	4
45°	468	178	13	1	0
55°	38	11	1	0	0
65°	0	0	0	0	0
75°	0	0	0	0	0
85°	0	0	0	0	0
90°	0	0	0	0	0

FOOTCANDLE VALUES

0° aiming angle - horizontal surface

D	C	FC	L	W
6'	0	127	1.6'	1.6'
8'	0	71	2.1'	2.1'
10'	0	46	2.6'	2.6'
12'	0	32	3.2'	3.2'
14'	0	23	3.7'	3.7'

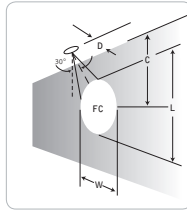
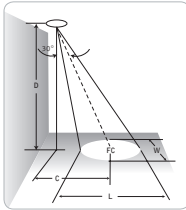

FOOTCANDLE VALUES

30° aiming angle - horizontal surface

D	C	FC	L	W
6'	3.5'	58	2.1'	1.8'
8'	4.6'	33	2.8'	2.4'
10'	5.8'	21	3.5'	3.0'
12'	6.9'	15	4.2'	3.6'
14'	8.1'	11	4.9'	4.3'

FOOTCANDLE VALUES

30° aiming angle - vertical surface

D	C	FC	L	W
2'	3.5'	176	2.2'	1.1'
3'	5.2'	79	3.3'	1.6'
4'	6.9'	45	4.4'	2.1'
5'	8.7'	28	5.6'	2.6'
6'	10.4'	20	6.7'	3.2'

Footcandle results based on AG132; off the shelf lamp in fixture, with soft focus lens; Reflectances=0/0/0; LLF=1

Go to www.focalpointlights.com for additional photometric data.