

6.75" x 6.75" – 57W downlight

id®



CFL



Patent Pending

features

Overlap trim features:

- One piece die-cast construction creates seamless integration with reflector eliminating mitered corners.
- Die-cast flange maintains tight fit of reflector corners.
- **SmartLock™** clip allows for quick removal and re-assembly of trim components for field painting.

Centered optics achieved with **CenterLock™** die-cast socket cup which locates and locks lamp in center of aperture.

LampAlign™ allows installation of upper reflector in any direction regardless of housing direction. Lamps are aligned for consistent appearance and light distribution.

Reflector design eliminates tabs in corners for a seamless, no light leaks look.

1" tall housing collar rotates up to 90°.

25-degree cut-off to lamp and its image.

Companion 26, 32, 42W luminare available.

dimensional data

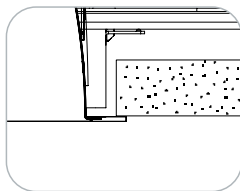
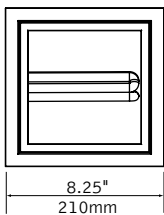
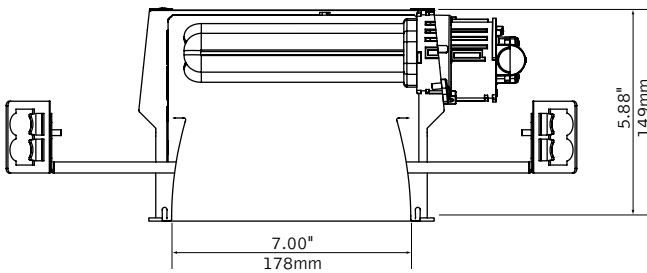

performance

1-Lamp 57W Triple Tube
 Downlight Optic, Clear Diffuse
 57% Efficiency
 1344 cd @ 5°

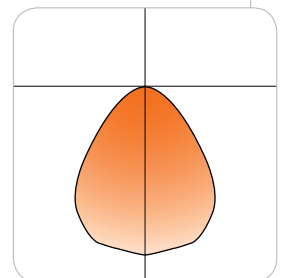

Visit focalpointlights.com for complete photometric data.

february 2011 D

fixture:
project:

details

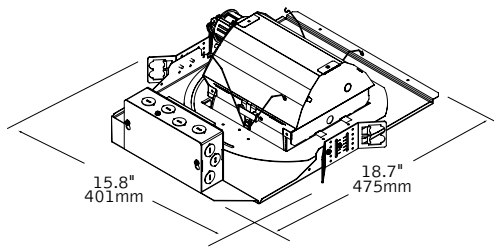

specifications

housing

Frame features up to 90-degree locking adjustment of aperture after installation for parallel alignment to walls or adjacent fixtures.

Frame may be installed into ceiling thicknesses up to 1". For thicker ceiling consult factory.

Flex conduit with screw tight fittings mechanically fasten to CenterLock™ socket cup. CenterLock™ provides proper venting for lamps.

Butterfly brackets allow mounting to ½ emt. Order bar hangers as an accessory. Galvanized steel frame includes large Junction box 7" x 3.5" with (10) ½" pry outs. UL listed for through branch wiring, four #12 90°C conductors.

upper reflector

Multi-faceted steel upper reflector mounts to steel end caps and is finished in High Reflectance White. 57W lamp is centered in the optic to maintain optimal performance.

trim

Lower reflector provides 25-degree cut off to lamp and lamp image.

Parabolic aluminum reflector fastens to die-cast trim flange.

Trim attaches to upper reflector via torsion springs.

Consult factory for custom reflector finishes.

Upper reflector and lower reflector ship separately from housing frame to avoid construction abuse.

Optional .125" thick Solite glass lens provides lamp obscuration.

electrical

Luminaires are pre-wired for single circuit with thermally protected Class "P" program start <10% THD electronic ballast.

Consult factory for dimming specifications and availability.

UL Listed.

Integral emergency battery test switch and indicator light in optic.

One lamp triple tube compact fluorescent, 57W (Gx24q-5).

57W push-in socket.

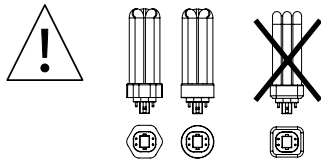

finish

Trim flange finished in polyester powder coat over a 5-stage pre-treatment.

housing ordering

housing series		<u>FC66</u>
ID CFL Square Housing	FC66	
lamp		<u>57TT</u>
57W Triple Tube, GX24q-5	57TT	
ballast		<u> </u>
Electronic Program Start <10% THD	S	
Electronic Dimming Ballast*	D	
voltage		<u> </u>
120V	120	
277V	277	
347V	347	
faceplate type		<u>S0</u>
Square Overlap	S0	
housing type		<u>T</u>
Thermally Protected, Non-IC	T	
factory options		<u> </u>
Chicago Plenum	CP	
Emergency Battery Pack*	EM	
HLR/GLR Fuse	FU	
Include 3000K Lamp	L830	
Include 3500K Lamp	L835	
Include 4100K Lamp	L841	

trim ordering

trim aperture		<u>D66</u>
6.75" Square Aperture	D66	
faceplate type		<u>S0</u>
Square Overlap	S0	
optic		<u> </u>
Downlight	DN57	
color		<u> </u>
Clear Diffuse	CD	
Warm Diffuse	WD	
Silver Talc Diffuse	TD	
flange finish		<u> </u>
White	WH	
Black	BK	
Titanium Silver	TS	
Aluminum Raw	AL	

a complete unit consists of two line items, housing and trim
example: FC66-57TT-S-120-S0-T
D66-S0-DN57-CD-WH

* for more information see Reference section.

6.75x6.75—57W downlight

id®



CFL

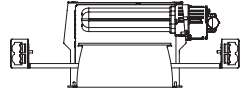

Filename: X.IES

Catalog #: FC66-57TT-S-120-S0-T, D66-S0-DN-CD-WH

Efficiency: 57%

Photometric Report #: 15398.0

CANDLEPOWER DISTRIBUTION

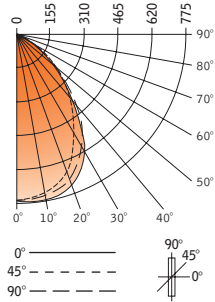

Spacing Criteria
End: 1.1
Cross: 1.2

Vertical Angle	Horizontal Angle					Zonal Lumens
	0°	22.5°	45°	67.5°	90°	
0°	1354	1354	1354	1354	1354	
5°	1340	1339	1341	1344	1344	128
15°	1253	1248	1272	1310	1320	363
25°	1059	1064	1145	1186	1204	524
35°	812	837	899	938	926	556
45°	559	567	608	521	494	430
55°	319	330	262	268	301	262
65°	136	132	112	124	149	127
75°	52	43	35	42	58	46
85°	10	9	7	7	10	9
90°	0	0	0	0	0	

LUMEN SUMMARY

Zone	Lumens	% Lamp	% Fixt
0°-30°	1014	23.6	41.5
0°-40°	1571	36.5	64.2
0°-60°	2264	52.6	92.6
0°-90°	2446	56.9	100.0
Total Luminaire	2446	56.9	100.0

LUMINANCE DATA (CD/M²)

Vertical Angle	0°	45°	90°
45°	26688	29027	23584
55°	18775	15420	17716
65°	10864	8946	11902
75°	6782	4565	7565
85°	3873	2711	3873

CO-EFFICIENTS OF UTILIZATION

	Floor				Ceiling				Wall			
	80	70	50	20	80	70	50	20	80	70	50	20
RCR 0	68	68	68	68	66	66	66	66	63	61	61	58
1	64	62	60	58	62	60	57	58	56	54	54	51
2	60	56	53	51	58	55	50	53	49	51	48	46
3	56	51	47	45	54	50	44	49	43	47	43	41
4	52	46	42	39	51	46	39	44	39	43	38	37
5	48	42	38	35	47	41	35	40	34	39	34	33
6	45	38	34	31	44	38	31	37	31	26	30	29
7	42	35	31	28	41	35	28	34	27	33	27	26
8	39	32	27	25	38	31	24	31	24	30	24	23
9	36	29	25	22	35	28	22	28	22	27	21	20
10	33	26	22	19	33	26	19	25	19	25	19	18

Numbers indicate percentage values of reflectivity.

Go to www.focalpointlights.com for additional photometric data.